

# 3 CHAPTER

---



---

## BALL VALVES AND DRAIN COCKS VANNES À SPHÈRE CARRÉ ET VANNES À BOISSEAU SPHÉRIQUE ШАРОВЫЕ КРАНЫ

---

|  |    |
|--|----|
| > BALL VALVES FOR WATER USE · VANNES À BOISSEAU SPHÉRIQUE POUR L'UTILISE D'EAU · ШАРОВЫЕ КРАНЫ         | 60 |
| > BALL VALVES FOR GAS USE · VANNES À BOISSEAU SPHÉRIQUE POUR L'UTILISE DE GAS · ШАРОВЫЕ КРАНЫ ДЛЯ ГАЗА | 70 |
| > DRAIN TAPS · ROBINETS DE VIDANGE · СЛИВНЫЕ КРАНЫ   | 76 |
| > ACCESSORIES AND SPARE PARTS · ACCESSOIRES ET PIÈCES DE RECHANGE · АКЦЕССУАРЫ И ЗАПАСНЫЕ ЧАСТИ        | 77 |
| > TECHNICAL AND DIMENSIONAL DATA   | 81 |

## > BALL VALVES FOR WATER USE

### VANNES À BOISSEAU SPHÉRIQUE POUR L'UTILISE D'EAU

### ШАРОВЫЕ КРАНЫ

#### Main features - Caractéristiques principales - Основные характеристики

Check the actual applications and certifications of the valve by consulting the specific Technical Datasheet. - Vérifier les applications et certifications effectives de la vanne en consultant la Communication Technique spécifique. - Применение и сертификация кранов: приводится в соответствующей технической документации.

Steel lever with plastic covering - Levier en acier à revêtement plastifié  
Рукоятка стальная с полимерным покрытием

External anti-friction ring  
Bague extérieure anti-friction  
Прокладка штока внешняя антифрикционная

Internal anti-friction ring  
Bague intérieure anti-friction  
Прокладка штока внутренняя антифрикционная

PTFE seals  
Etanchéités en PTFE  
Уплотнения из PTFE

**Guarantee seal with hologram**  
**Sceau de garantie avec hologramme**  
**Гарантийная пломба с голограммой**

Double O-ring seal in FKM  
Double joint torique d'étanchéité en FKM  
Два уплотнительных кольца штока из FKM

Stem fitted from the inside  
Tige montée de l'intérieur  
Шток, вставляемый изнутри

NUT sphere - Bille ÉCROU - Шар DADO

Certifications available: EC mark in compliance with PED (check models/measurements in the specific Technical Datasheet).  
Certifications disponibles: marquage CE conformément à la PED (vérifier les modèles/les mesures dans la Communication Technique spécifique).  
Сертификация: знак CE в соответствии с PED (информация о моделях и размерах приводится в соответствующей технической документации).

## R950

| PRODUCT CODE | SIZE   | □  | ⊞   |
|--------------|--------|----|-----|
| R950X021     | 1/4"   | 20 | 200 |
| R950X022     | 3/8"   | 10 | 100 |
| R950X023     | 1/2"   | 5  | 50  |
| R950X024     | 3/4"   | 5  | 50  |
| R950X025     | 1"     | 5  | 25  |
| R950X026     | 1 1/4" | 4  | 20  |
| R950X027     | 1 1/2" | 2  | 10  |
| R950X028     | 2"     | 2  | 10  |



DADO

Full port DADO ball valve, heavy series, nickel plated, red level handle.

Vanne à boisseau sphérique DADO, modèle lourd, passage intégral, poignée rouge, nickelée.

Кран шаровый полнопроходный с шаром DADO, усиленная модель, резьба внутренняя/внутренняя, никелированный, ручка - рычаг красный.

## R951

| PRODUCT CODE | SIZE   | □  | ⊞   |
|--------------|--------|----|-----|
| R951X021     | 1/4"   | 20 | 200 |
| R951X022     | 3/8"   | 10 | 100 |
| R951X023     | 1/2"   | 10 | 100 |
| R951X024     | 3/4"   | 5  | 50  |
| R951X025     | 1"     | 5  | 25  |
| R951X026     | 1 1/4" | 4  | 20  |



DADO

Full port DADO ball valve, heavy series, nickel plated, red T handle.

Vanne à boisseau sphérique DADO, modèle lourd, passage intégral, papillon rouge, nickelée.

Кран шаровый полнопроходный с шаром DADO, усиленная модель, резьба внутренняя/внутренняя, никелированный, ручка - бабочка красная.

## R910

| PRODUCT CODE | SIZE   | □  | ⊞   |
|--------------|--------|----|-----|
| R910X022     | 3/8"   | 10 | 100 |
| R910X023     | 1/2"   | 10 | 100 |
| R910X024     | 3/4"   | 5  | 50  |
| R910X025     | 1"     | 5  | 25  |
| R910X026     | 1 1/4" | 4  | 20  |
| R910X027     | 1 1/2" | 2  | 10  |
| R910X028     | 2"     | 2  | 10  |
| R910X029     | 2 1/2" | 2  | 4   |
| R910X030     | 3"     | 1  | 2   |
| R910X031     | 4"     | 1  | 2   |



DADO

Full port DADO ball valve, compact pattern, red lever handle, nickel plated.

Vanne à boisseau sphérique DADO, passage intégral, poignée rouge, nickelée.

Кран шаровый полнопроходный с шаром DADO, резьба внутренняя/внутренняя, никелированный, ручка - рычаг красный.

## R910S

| PRODUCT CODE | SIZE   | □ | ⊞  |
|--------------|--------|---|----|
| R910SX003    | 1/2"   | 5 | 50 |
| R910SX004    | 3/4"   | 5 | 25 |
| R910SX005    | 1"     | 5 | 25 |
| R910SX006    | 1 1/4" | 2 | 20 |
| R910SX007    | 1 1/2" | 2 | 10 |
| R910SX008    | 2"     | 2 | 10 |



DADO

Full port DADO ball valve with drain tap, chrome plated.

Vanne à boisseau sphérique DADO, à passage direct avec robinet de vidange, chromée.

Кран шаровый со сливом полнопроходной с шаром DADO, резьба внутренняя/внутренняя, никелированный, ручка - рычаг красный.

#### NOTES

1/2" - 3/4" - 1": drain tap 1/4" · robinet de purge 1/4" · подключение сливного крана 1/4".

1 1/4": drain tap 3/8" · robinet de purge 3/8" · подключение сливного крана 3/8".

## R913

| PRODUCT CODE | SIZE   | □  | ▣   |
|--------------|--------|----|-----|
| R913X022     | 3/8"   | 10 | 100 |
| R913X023     | 1/2"   | 5  | 50  |
| R913X024     | 3/4"   | 5  | 50  |
| R913X025     | 1"     | 5  | 25  |
| R913X026     | 1 1/4" | 2  | 20  |

Male x male full port DADO ball valve, compact pattern, nickel plated, red T handle.

Vanne à boisseau sphérique DADO mâle mâle, nickelé à passage intégral, avec papillon.

Кран шаровый полнопроходный с шаром DADO, резьба наружная/наружная, никелированный, ручка - бабочка красная.



DADO



## R913L

| PRODUCT CODE | SIZE   | □  | ▣   |
|--------------|--------|----|-----|
| R913LX022    | 3/8"   | 10 | 100 |
| R913LX023    | 1/2"   | 5  | 50  |
| R913LX024    | 3/4"   | 5  | 50  |
| R913LX025    | 1"     | 2  | 20  |
| R913LX026    | 1 1/4" | 2  | 20  |

Male x male full port DADO ball valve, compact pattern, nickel plated, red lever handle.

Vanne à boisseau sphérique DADO mâle mâle, passage intégral, poignée rouge, nickelée.

Кран шаровый полнопроходный с шаром DADO, резьба наружная/наружная, никелированный, ручка - рычаг красный.



DADO



## R914

| PRODUCT CODE | SIZE   | □  | ▣   |
|--------------|--------|----|-----|
| R914X021     | 1/4"   | 20 | 200 |
| R914X022     | 3/8"   | 10 | 100 |
| R914X023     | 1/2"   | 10 | 100 |
| R914X024     | 3/4"   | 5  | 50  |
| R914X025     | 1"     | 5  | 25  |
| R914X026     | 1 1/4" | 2  | 20  |

Male x female, full port DADO ball valve, compact pattern, red T handle, nickel plated.

Vanne à boisseau sphérique DADO mâle femelle, nickelé à passage intégral, avec papillon.

Кран шаровый полнопроходный с шаром DADO, резьба внутренняя/наружная, никелированный, ручка - бабочка красная.



DADO



## R914L

| PRODUCT CODE | SIZE   | □  | ▣   |
|--------------|--------|----|-----|
| R914LX021    | 1/4"   | 20 | 200 |
| R914LX022    | 3/8"   | 10 | 100 |
| R914LX023    | 1/2"   | 5  | 50  |
| R914LX024    | 3/4"   | 5  | 50  |
| R914LX025    | 1"     | 2  | 20  |
| R914LX026    | 1 1/4" | 2  | 20  |
| R914LX027    | 1 1/2" | 2  | 10  |
| R914LX028    | 2"     | 2  | 10  |

Male x female full port DADO ball valve, compact pattern, red lever handle, nickel plated.

Vanne à boisseau sphérique DADO mâle femelle, passage intégral, poignée rouge, nickelée.

Кран шаровый полнопроходный с шаром DADO, резьба внутренняя/наружная, никелированный, ручка - рычаг красный.



DADO



## R919

| PRODUCT CODE | SIZE              | □ | ▣  |
|--------------|-------------------|---|----|
| R919X003     | 1/2"F x 1/2"M     | 5 | 50 |
| R919X004     | 1/2"F x 3/4"M     | 5 | 50 |
| R919X005     | 3/4"F x 3/4"M     | 5 | 25 |
| R919X006     | 3/4"F x 1"M       | 2 | 20 |
| R919X007     | 1"F x 1"M         | 2 | 20 |
| R919X008     | 1"F x 1 1/4"M     | 2 | 20 |
| R919X009     | 1 1/4"F x 1 1/4"M | 2 | 20 |

Full port DADO ball valve, compact pattern, nickel plated, with red T handle and male-female connections.

Vanne à boisseau sphérique DADO, mâle femelle, avec papillon rouge, passage intégral, série lourde, nickelée.

Кран шаровый полнопроходный с отводом с накидной гайкой с шаром DADO, резьба внутренняя/наружная, никелированный, ручка - бабочка красная.



DADO



## R919S

| PRODUCT CODE | SIZE              | □ | ▣  |
|--------------|-------------------|---|----|
| R919SX003    | 1/2"F x 1/2"M     | 5 | 50 |
| R919SX004    | 1/2"F x 3/4"M     | 5 | 50 |
| R919SX005    | 3/4"F x 3/4"M     | 5 | 25 |
| R919SX006    | 3/4"F x 1"M       | 2 | 20 |
| R919SX007    | 1"F x 1"M         | 2 | 20 |
| R919SX008    | 1"F x 1 1/4"M     | 2 | 20 |
| R919SX009    | 1 1/4"F x 1 1/4"M | 2 | 10 |

Full port DADO ball valve, with tailpiece and drain tap, red T handle, nickel plated.

Vanne à boisseau sphérique DADO, mâle femelle, avec papillon rouge e vidange, passage intégral, série lourde, nickelée.

Кран шаровый со сливом полнопроходный с отводом с накидной гайкой с шаром DADO, резьба внутренняя/наружная, никелированный, ручка - бабочка красная.

### NOTES

1/2" - 3/4" - 1": drain tap 1/4" · robinet de purge 1/4" подключение сливного крана 1/4".

1 1/4": drain tap 3/8" · robinet de purge 3/8" подключение сливного крана 3/8".



DADO



## R911

| PRODUCT CODE | SIZE   | □  | ▣   |
|--------------|--------|----|-----|
| R911X022     | 3/8"   | 10 | 100 |
| R911X023     | 1/2"   | 10 | 100 |
| R911X024     | 3/4"   | 5  | 50  |
| R911X025     | 1"     | 5  | 25  |
| R911X026     | 1 1/4" | 4  | 20  |

Full port DADO ball valve, compact pattern, nickel plated, red T handle.

Vanne à boisseau sphérique DADO, passage intégral, papillon rouge, nickelée.

Кран шаровый полнопроходный с шаром DADO, резьба внутренняя/внутренняя, никелированный, ручка - бабочка красная.



DADO



## R918

| PRODUCT CODE | SIZE | □ | ▣  |
|--------------|------|---|----|
| R918Y003     | Ø15  | 1 | 10 |
| R918Y004     | Ø22  | 1 | 6  |
| R918Y005     | Ø28  | 1 | 6  |
| R918Y006     | Ø35  | 1 | 4  |

Full port DADO ball valve solder end.

Vanne à boisseau sphérique DADO, nickelée à passage intégral à souder.

Кран шаровый полнопроходный с шаром DADO, отводы под пайку, ручка - рычаг красный.



DADO



## R789

| PRODUCT CODE | SIZE            | □ | ⊞  |
|--------------|-----------------|---|----|
| R789X003     | 1/2" F x 1/2" M | 5 | 50 |
| R789X005     | 3/4" F x 3/4" M | 5 | 25 |
| R789X007     | 1" F x 1" M     | 2 | 20 |

Angle ball valve, chrome plated, red T handle and male-female connections.

Vanne à sphère équerre mâle femelle chromée avec papillon rouge.

Кран шаровый угловой полнопроходный с отводом с накидной гайкой, резьба внутренняя/наружная, ручка - бабочка красная, хромированный.



## R854

| PRODUCT CODE | SIZE   | □  | ⊞   |
|--------------|--------|----|-----|
| R854X023     | 1/2"   | 10 | 100 |
| R854X024     | 3/4"   | 5  | 50  |
| R854X025     | 1"     | 5  | 25  |
| R854X026     | 1 1/4" | 4  | 20  |

Full port, chrome plated, ball valve with red T handle and female connections.

Vanne à boisseau sphérique mâle x femelle, passage intégral, poignée papillon rouge, chromée.

Кран шаровый полнопроходный, резьба внутренняя/наружная, хромированный, ручка - бабочка красная.



## R850

| PRODUCT CODE | SIZE   | □  | ⊞   |
|--------------|--------|----|-----|
| R850X021     | 1/4"   | 20 | 200 |
| R850X022     | 3/8"   | 10 | 100 |
| R850X023     | 1/2"   | 10 | 100 |
| R850X024     | 3/4"   | 5  | 50  |
| R850X025     | 1"     | 5  | 25  |
| R850X026     | 1 1/4" | 4  | 20  |
| R850X027     | 1 1/2" | 4  | 20  |
| R850X028     | 2"     | 2  | 10  |

Full port ball valve, red lever handle, chrome plated.

Vanne à boisseau sphérique, passage intégral, poignée rouge, chromée.

Кран шаровый полнопроходный, резьба внутренняя/внутренняя, хромированный, ручка - рычаг красный.



## R859

| PRODUCT CODE | SIZE                | □ | ⊞  |
|--------------|---------------------|---|----|
| R859X023     | 1/2" F x 1/2" M     | 1 | 50 |
| R859X025     | 3/4" F x 3/4" M     | 1 | 25 |
| R859X027     | 1" F x 1" M         | 1 | 20 |
| R859X029     | 1 1/4" F x 1 1/4" M | 1 | 20 |

Full port, chrome plated, ball valve with red T handle and female connections.

Vanne à boisseau sphérique, passage intégral, papillon rouge, chromée.

Кран шаровый полнопроходный с отводом с накидной гайкой, резьба внутренняя/наружная, хромированный, ручка - бабочка красная.



## R851

| PRODUCT CODE | SIZE   | □  | ⊞   |
|--------------|--------|----|-----|
| R851X021     | 1/4"   | 20 | 200 |
| R851X022     | 3/8"   | 10 | 100 |
| R851X023     | 1/2"   | 10 | 100 |
| R851X024     | 3/4"   | 5  | 50  |
| R851X025     | 1"     | 5  | 50  |
| R851X026     | 1 1/4" | 5  | 25  |

Full port, chrome plated, ball valve with red T handle and female connections.

Vanne à boisseau sphérique, passage intégral, poignée papillon rouge, chromée.

Кран шаровый полнопроходный, резьба внутренняя/внутренняя, хромированный, ручка - бабочка красная.



## R859K

| PRODUCT CODE | SIZE    | □ | ⊞  |
|--------------|---------|---|----|
| R859KY007    | 1" x 1" | 1 | 10 |

Kit of nr. 2 R859 ball valves with red and blue T handle.

Kit de nr. 2 R859 vannes à boisseau avec poignée en T rouge et bleu.

Комплект из двух шаровых кранов. Ручка бабочка, цвет ручек синий и красный.



## R851TH

| PRODUCT CODE | SIZE   | □  | ⊞  |
|--------------|--------|----|----|
| R851TX002    | 3/8"   | 0  | -  |
| R851TX003    | 1/2"   | 0  | -  |
| R851TX004    | 3/4"   | 10 | 50 |
| R851TX005    | 1"     | 0  | -  |
| R851TX006    | 1 1/4" | 0  | -  |
| R851TX007    | 1 1/2" | 2  | 20 |
| R851TX008    | 2"     | 2  | 10 |

Full port chrome plated valve with extended handle, suitable for installations with high insulating thickness.

Vanne à sphère chromée à passage direct avec poignée surélevée, spécifique pour installation avec épaisseur importante d'isolant.

Кран шаровый полнопроходный, резьба внутренняя/внутренняя, хромированный, ручка пластиковая удлиненная для труб с термоизоляцией.





## Main features of the ball valves with press-on connections

### Caractéristiques principales des vannes à billes avec raccords à estamper

### Основные характеристики шаровых кранов с пресс соединением

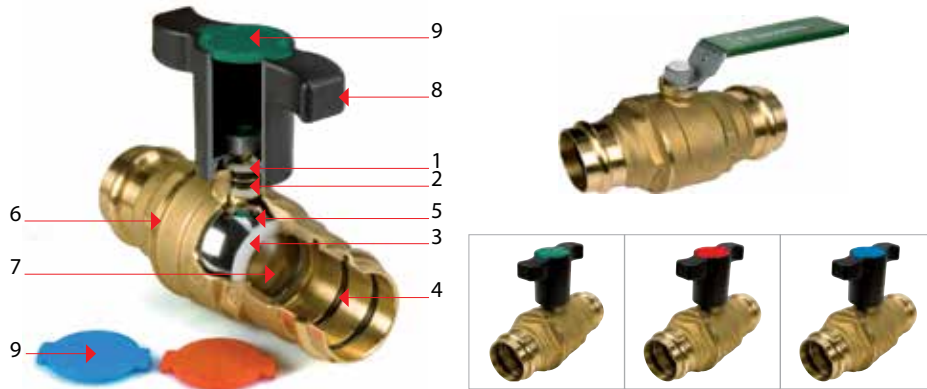

#### MATERIALS - MATÉRIAUX - МАТЕРИАЛЫ:

- Body in hot-stamped brass CW617N - EN 12165, with double black O-ring in alimentary-approved EPDM complying with EN 681-1.  
Corps en laiton estampé à chaud CW617N - EN 12165, avec double joint torique noir en EPDM alimentaire conforme à la norme EN 681-1.  
Корпус из латуни CW617N - EN 12165, с двойным кольцевым уплотнением из EPDM, совместимого с питьевой водой, в соответствии с EN 681-1.
- Sleeve in hot-stamped brass CW617N - EN 12165, with double black O-ring in alimentary-approved EPDM complying with EN 681-1.  
Manchon en laiton estampé à chaud CW617N - EN 12165, avec double joint torique noir en EPDM alimentaire conformes à la norme EN 681-1.  
Втулка из латуни CW617N - EN 12165, с двойным уплотнительным кольцом из EPDM, совместимого с питьевой водой, в соответствии с EN 681-1.
- Stem in brass obtained from bar CW614N - EN 12164, with internal and external anti-friction rings and double O-ring seal.  
Tige en laiton usiné à partir d'une barre CW614N - EN 12164, avec bagues intérieure et extérieure anti-frottement et double joint torique d'étanchéité.  
Шток из латуни CW614N - EN 12164, с внутренней и внешней антифрикционными прокладками и двумя уплотнительными прокладками.
- Full port ball in brass CW617N, chrome-plated.  
Bille en laiton CW617N, chromée à passage intégral.  
Сферический затвор из латуни CW617N, хромированный.
- Gaskets in PTFE with a low-friction profile.  
Joints en PTFE avec profil à bas frottement.  
Прокладки пониженного трения из PTFE.
- Extended butterfly handle in glass-charged polyamide with steel reinforcement plate on the base for R851VT, or steel lever with green plastic covering for R850VW.  
Poignée papillon prolongée en polyamide chargée de verre avec plaquette de renfort sur la base en acier pour R851VT ou à levier en acier avec revêtement plastifié vert pour R850VW.  
Ручка-бабочка увеличенного размера из стеклонеполненного полиамида с армирующим основанием из стали, для R851VT, или стальной рычаг с полимерным покрытием зеленого цвета для R850VW.
- Nut with anti-corrosion chemical covering, safety seal and hologram.  
Écrou avec revêtement chimique anti-corrosion, sceau de garantie et hologramme.  
Гайка с антикоррозионным покрытием, пломбой и голограммой.

- 1 Stem with internal and external anti-friction ring and double O-ring seal. · Tige dotée d'une bague intérieure et extérieure anti-frottement et d'un double joint torique d'étanchéité.  
Шток с антифрикционными прокладками и двумя уплотнительными кольцами из FPM.
- 2 Stem fitted from the inside, to offer greater protection against tampering. · Tige montée de l'intérieur, qui garantit une sécurité supérieure contre l'altération. · Шток вставлен изнутри, для защиты от выбивания избыточным давлением.
- 3 The PTFE gaskets with low friction profile ensure easy opening/closure of the valve, whilst still guaranteeing a good seal. · Les joints en PTFE avec un profil à bas frottement favorisent une opération d'ouverture-fermeture facile du vanne, garantissant ainsi la sécurité de l'étanchéité.  
прокладки пониженного трения из PTFE обеспечивают легкое открытие и закрытие крана, гарантируя его герметичность.
- 4 2 O-rings on the press-on connection guarantee an excellent seal and improved pipe positioning during pressing (better guide). · 2 Joints toriques sur le raccordement à estamper garantissent une excellente étanchéité et un meilleur positionnement du tube pendant l'estampage (meilleure guidage pendant l'estampage). · Два кольцевых уплотнения на пресс соединении гарантируют превосходное уплотнение и позиционирование трубы во время обжатия.
- 5 Ball surface diamond-sanded and chrome-plated for a long lifespan. · Surface de la bille polie avec diamantage et chromée garantissant une longue durée de vie.  
Полирование хромированной поверхности обеспечивает большой ресурс.
- 6 Body and ball in brass complying with Ministerial Decree No. 174 of 06/04/2004 for use in systems in contact with drinking water. · Corps et bille en laiton conforme au D.M. N° 174 du 06/04/2004 pour l'utilisation dans des installations au contact de l'eau potable. · Корпус и шар выполнены из латуни, в соответствии с декретом No. 174 of 06/04/2004, для использования в системах питьевого водоснабжения.
- 7 Additional hole on the bottom of the ball, to guarantee a constant exchange of the water which settles between the ball and valve body during manoeuvre operations. This constant water change prevents the formation of bacterial colonies. · Trou supplémentaire sur le fond de la bille pour garantir l'échange constant de l'eau qui, pendant les opérations de manoeuvre, se dépose entre la bille et le corps de vanne. Cet échange d'eau constant prévient le développement de colonies bactériennes. · Дополнительное отверстие в дне шара, для циркуляции воды в пространстве между шаром и корпусом, для предотвращения бактериального размножения.
- 8 T-handle in shock-proof plastic or handle with plastic lever for greater resistance. · Poignée en T en matière plastique anti-choc ou poignée à levier plastifiée pour une résistance supérieure.  
· Ручка-бабочка из ударопрочного пластика, или рычаг с пластиковым покрытием, для снижения усилия поворота затворного узла.
- 9 Possibility to replace the plate in the R851VT models, depending on the application: hot water (red), cold water (blue), or drinking water (green). · Possibilité de remplacer la plaquette dans les R851VT selon l'application: eau chaude (rouge), eau froide (bleu) ou potable (vert). · Возможность замены вставки для моделей R851VT, в соответствии с применением: горячая вода (красная), холодная вода (синяя), питьевая вода (зеленая).

## R850VW

| PRODUCT CODE | SIZE | □ | ⊞  |
|--------------|------|---|----|
| R850VY137    | Ø42  | 2 | 12 |
| R850VY138    | Ø54  | 2 | 10 |

Brass finished ball valve, press-fitting connections, with black o-ring according to EN 681-1 standard for water distribution systems (sanitary and heating), green lever handle. Full port. W series. Pressable with "V" profile tongs.

Vanne à sphère laiton, raccordement à sertir avec joint O-ring noir conforme à la norme EN681-1 pour installation de distribution d'eau (potable et de chauffage), poignée verte. Passage intégral. Série W.

Кран шаровый латунный, соединение под пресс с кольцевым уплотнением, согласно норматива EN681-1, для водопроводных установок (питьевая вода и системы отопления), зеленый рычаг. Полнопроходный. Серия W.



## R850VWS

| PRODUCT CODE | SIZE           | □ | ⊞  |
|--------------|----------------|---|----|
| R850VY157    | 1 1/2" F x Ø42 | 2 | 10 |
| R850VY158    | 2" F x Ø54     | 2 | 8  |

Brass finish ball valve, female press-connections with black o-ring in compliance with EN681-1 for water distribution systems (sanitary and heating), green lever handle and drain tap. Full port. W series. Pressable with "V" profile tongs.

Vanne à sphère laiton, raccordement femelle à sertir avec joint O-ring noir conforme à la norme EN681-1 pour installation de distribution d'eau (potable et de chauffage), avec poignée verte et robinet de vidange. Passage intégral. Série W.

Кран шаровый со сливом латунный, внутреннее пресс-соединение с кольцевым уплотнением, в соответствии с EN681-1 для систем распределения воды (питьевая вода и отопление), зеленая ручка. Полнопроходной. W серии.

#### NOTES

Drain tap 3/8" · robinet de purge 3/8" · подсоединение сливного клапана 3/8"

## R851VT

| PRODUCT CODE | SIZE | □ | ⊞  |
|--------------|------|---|----|
| R851VY102    | Ø18  | 5 | 50 |
| R851VY103    | Ø15  | 5 | 30 |
| R851VY104    | Ø22  | 3 | 30 |
| R851VY105    | Ø28  | 3 | 15 |
| R851VY106    | Ø35  | 2 | 10 |

Brass-finished ball valve, press-fitting connections, with black o-ring according to EN 681-1 standard for water distribution systems (sanitary and heating), with plastic extended T handle for pipes with high insulating thickness. Full port. W series. Pressable with "V", "SA" or "M" profile tongs.

Vanne à sphère non chromée, raccordement à sertir avec joint O-ring noir conforme à la norme EN681-1 pour installation de distribution d'eau (potable et de chauffage) et avec poignée papillon rallongée en plastique, pour montage sur tube isolé. Passage intégral. Série W.

Кран шаровый латунный, пресс-соединение, с кольцевым уплотнением в соответствии со стандартом EN681-1 для систем распределения воды (питьевая и отопление), имеет удлиненную пластиковую ручку для труб с термоизоляцией. Полнопроходный. W-серии.



### NOTES

The package includes: 1 red plate, 1 blue plate, 1 green plate.

Le kit comprend: 1 plaque rouge, 1 plaque bleue, 1 plaque verte.  
В комплекте: 1 красная вставка, 1 синяя вставка, 1 зеленая вставка.

## R853VT

| PRODUCT CODE | SIZE           | □ | ⊞  |
|--------------|----------------|---|----|
| R853VY102    | Ø18 x 1 1/2" M | 5 | 50 |
| R853VY103    | Ø15 x 1/2" M   | 5 | 50 |
| R853VY104    | Ø22 x 3/4" M   | 3 | 30 |
| R853VY105    | Ø28 x 1" M     | 3 | 30 |
| R853VY106    | Ø35 x 1 1/4" M | 2 | 10 |

Brass finish ball valve, male press-connections with black o-ring in compliance with EN681-1 for water distribution systems (sanitary and heating), with plastic extended T handle for pipes having high insulating thickness. Full port. W series. Pressable with "V", "SA" or "M" profile tongs.

Vanne à sphère non chromée, raccordement mâle à sertir avec joint O-ring noir conforme à la norme EN681-1 pour installation de distribution d'eau (potable et de chauffage), avec poignée papillon rallongée en plastique, pour montage sur tube isolé. Passage intégral. Série W.

Кран шаровый латунный, внешнее пресс-соединение с кольцевым уплотнением, в соответствии с EN681-1 для систем распределения воды (питьевая вода и отопление), имеет удлиненную пластиковую ручку для труб с термоизоляцией. Полнопроходный. W серии.



### NOTES

The package includes: 1 red plate, 1 blue plate, 1 green plate.

Le kit comprend: 1 plaque rouge, 1 plaque bleue, 1 plaque verte.  
В комплекте: 1 красная вставка, 1 синяя вставка, 1 зеленая вставка.

## R854VT

| PRODUCT CODE | SIZE           | □ | ⊞  |
|--------------|----------------|---|----|
| R854VY102    | Ø18 x 1/2" F   | 5 | 50 |
| R854VY103    | Ø15 x 1/2" F   | 5 | 50 |
| R854VY104    | Ø22 x 3/4" F   | 3 | 30 |
| R854VY105    | Ø28 x 1" F     | 3 | 30 |
| R854VY106    | Ø35 x 1 1/4" F | 2 | 20 |

Brass finish ball valve, female press-connections with black o-ring in compliance with EN681-1 for water distribution systems (sanitary and heating), with plastic extended T handle for pipes having high insulating thickness. Full port. W series. Pressable with "V", "SA" or "M" profile tongs.

Vanne à sphère laiton, raccordement femelle à sertir avec joint O-ring noir conforme à la norme EN681-1 pour installation de distribution d'eau (potable et de chauffage), avec poignée papillon rallongée en plastique, pour montage sur tube isolé. Passage intégral. Série W.

Кран шаровый латунный, внутреннее пресс-соединение с кольцевым уплотнением, в соответствии с EN681-1 для систем распределения воды (питьевая вода и отопление), имеет удлиненную ручку из пластика для труб с термоизоляцией. Полнопроходный. W серии.



### NOTES

The package includes: 1 red plate, 1 blue plate, 1 green plate.

Le kit comprend: 1 plaque rouge, 1 plaque bleue, 1 plaque verte.  
В комплекте: 1 красная вставка, 1 синяя вставка, 1 зеленая вставка.

## R851VTS

| PRODUCT CODE | SIZE           | □ | ⊞  |
|--------------|----------------|---|----|
| R851VY152    | 1/2" F x Ø18   | 5 | 50 |
| R851VY153    | 1/2" F x Ø15   | 5 | 50 |
| R851VY154    | 3/4" F x Ø22   | 3 | 30 |
| R851VY155    | 1" F x Ø28     | 3 | 30 |
| R851VY156    | 1 1/4" F x Ø35 | 2 | 10 |

Brass finish ball valve, female press-connections with black o-ring in compliance with EN681-1 for water distribution systems (sanitary and heating), with plastic extended T handle for pipes having high insulating thickness. Full port. W series. Pressable with "V", "SA" or "M" profile tongs.

Vanne à sphère non chromée, raccordement femelle à sertir avec joint O-ring noir conforme à la norme EN681-1 pour installation de distribution d'eau (potable et de chauffage), avec poignée papillon rallongée en plastique, pour montage sur tube isolé. Passage intégral. Série W.

Кран шаровый латунный, внутреннее пресс-соединение с кольцевым уплотнением, в соответствии с EN681-1 для систем распределения воды (питьевая вода и отопление), имеет удлиненную пластиковую ручку для труб с термоизоляцией. Полнопроходный. W серии.



### NOTES

1/2" - 3/4" - 1":  
drain tap 1/4"  
· robinet de purge  
1/4" · подключение  
сливного крана 1/4".  
1 1/4": drain tap 3/8"  
· robinet de purge  
3/8" · подключение  
сливного крана 3/8".

The package includes: 1 red plate, 1 blue plate, 1 green plate.

Le kit comprend: 1 plaque rouge, 1 plaque bleue, 1 plaque verte.  
В комплекте: 1 красная вставка, 1 синяя вставка, 1 зеленая вставка.

## R859VT

| PRODUCT CODE | SIZE           | □ | ⊞  |
|--------------|----------------|---|----|
| R859VY102    | Ø18 x 1/2" M   | 5 | 50 |
| R859VY103    | Ø15 x 1/2" M   | 5 | 50 |
| R859VY104    | Ø22 x 3/4" M   | 3 | 30 |
| R859VY105    | Ø28 x 1" M     | 3 | 15 |
| R859VY106    | Ø35 x 1 1/4" M | 2 | 10 |

Brass finish ball valve, male press-connections with tail piece, having black o-ring in compliance with EN681-1 for water distribution systems (sanitary and heating), with plastic extended T handle for pipes having high insulating thickness. Full port. W series. Pressable with "V", "SA" or "M" profile tongs.

Vanne à sphère laiton, raccordement mâle à sertir avec joint O-ring noir conforme à la norme EN681-1 pour installation de distribution d'eau (potable et de chauffage), avec poignée papillon rallongée en plastique, pour montage sur tube isolé. Passage intégral. Série W.

Кран шаровый латунный, внешнее пресс-соединение с кольцевым уплотнением, в соответствии с EN681-1 для систем распределения воды (питьевая вода и отопление), имеет удлиненную пластиковую ручку для труб с термоизоляцией. Полнопроходный. W серии.



### NOTES

The package includes: 1 red plate, 1 blue plate, 1 green plate.

Le kit comprend: 1 plaque rouge, 1 plaque bleue, 1 plaque verte.  
В комплекте: 1 красная вставка, 1 синяя вставка, 1 зеленая вставка.

## R251WP

### chrome plated - chromé - хромированный

| PRODUCT CODE | SIZE              | □ | ⊞  |
|--------------|-------------------|---|----|
| R251WX073    | 1/2" F x 3/4" nut | 5 | 50 |
| R251WX074    | 3/4" F x 3/4" nut | 5 | 50 |
| R251WX075    | 3/4" F x 1" nut   | 5 | 50 |
| R251WX076    | 1" F x 1" nut     | 5 | 25 |

### brass finish - laiton - нехромированный

| PRODUCT CODE | SIZE              | □ | ⊞  |
|--------------|-------------------|---|----|
| R251WY073    | 1/2" F x 3/4" nut | 5 | 50 |
| R251WY074    | 3/4" F x 3/4" nut | 5 | 50 |
| R251WY075    | 3/4" F x 1" nut   | 5 | 50 |
| R251WY076    | 1" F x 1" nut     | 5 | 25 |

Ball valve female-female with meterconnection with reduced percentage of lead. Suitable for sanitary water.

Vanne à sphère femelle-femelle à écrou prisonnier, avec pourcentage réduit de plomb. Convient pour l'eau potable.

Кран шаровый с внутренней резьбой, с отводом с накидной гайкой для счетчиков, с низким содержанием свинца, для питьевой воды.



## R853VWL

| PRODUCT CODE     | SIZE           | □ | ⊞  |
|------------------|----------------|---|----|
| <b>R853VY137</b> | 1 1/2" M x Ø42 | 2 | 10 |
| <b>R853VY138</b> | 2" F x Ø54     | 2 | 10 |

Brass finish ball valve, male press-connections with black o-ring in compliance with EN681-1 for water distribution systems (sanitary and heating), green lever handle. Full port. W series. Pressable with "V" profile tongs.

Vanne à sphère laiton, raccord mâle à sertir avec joint O-ring noir conforme à la norme EN681-1 pour installation de distribution d'eau (potable et de chauffage), avec poignée verte. Passage intégral. Serie W.

Кран шаровый латунный, внешнее пресс-соединение с кольцевым уплотнением, в соответствии с EN681-1 для систем распределения воды (питьевая вода и отопление), зеленая ручка. Полнопроходный. W серии.



## R854VWL

| PRODUCT CODE     | SIZE           | □ | ⊞  |
|------------------|----------------|---|----|
| <b>R854VY137</b> | Ø42 x 1 1/2" F | 2 | 12 |
| <b>R854VY138</b> | Ø54 x 2" F     | 2 | 10 |

Brass finish ball valve, female press-connections with black o-ring in compliance with EN681-1 for water distribution systems (sanitary and heating), green lever handle. Full port. W series. Pressable with "V" profile tongs.

Vanne à sphère laiton, raccordement femelle à sertir avec joint O-ring noir conforme à la norme EN681-1 pour installation de distribution d'eau (potable et de chauffage), avec poignée verte. Passage intégral. Série W.

Кран шаровый латунный, внутреннее пресс-соединение с кольцевым уплотнением, в соответствии с EN681-1 для систем распределения воды (питьевая вода и отопление), ручка-рычаг зеленого цвета. Полнопроходный. W серии.



## R250W

| PRODUCT CODE     | SIZE   | □  | ⊞   |
|------------------|--------|----|-----|
| <b>R250WX022</b> | 3/8"   | 10 | 100 |
| <b>R250WX023</b> | 1/2"   | 10 | 100 |
| <b>R250WX024</b> | 3/4"   | 5  | 50  |
| <b>R250WX025</b> | 1"     | 5  | 25  |
| <b>R250WX026</b> | 1 1/4" | 5  | 25  |
| <b>R250WX027</b> | 1 1/2" | 2  | 10  |
| <b>R250WX028</b> | 2"     | 2  | 10  |

Standard port ball valve, green lever handle, chrome plated with reduced percentage of lead. Suitable for sanitary water.

Vanne à sphère nickelée et chromée avec pourcentage réduit de plomb. Poignée verte. Convient pour l'eau potable.

Кран шаровый со стандартным проходом, с зеленой рычажной рукояткой, хромированный, с низким содержанием свинца, для питьевой воды.



## R250WS

| PRODUCT CODE     | SIZE   | □ | ⊞  |
|------------------|--------|---|----|
| <b>R250SX143</b> | 1/2"   | 5 | 50 |
| <b>R250SX144</b> | 3/4"   | 5 | 50 |
| <b>R250SX145</b> | 1"     | 5 | 25 |
| <b>R250SX146</b> | 1 1/4" | 4 | 20 |
| <b>R250SX147</b> | 1 1/2" | 2 | 10 |
| <b>R250SX148</b> | 2"     | 2 | 10 |

Chrome plated ball valve, female connections, green lever handle and with drain tap. Standard port. Suitable for sanitary water.

Vanne à sphère chromée, raccord femelle, poignée verte, avec robinet de purge. Port standard.

Кран шаровый со сливом, резьба внутренняя/внутренняя, ручка рычаг зеленый. Стандартный проход.



### NOTES

1/2" - 3/4" - 1": drain tap 1/4" · robinet de purge 1/4" · сливной кран 1/4".  
1 1/4" - 1 1/2" - 2": drain tap 3/8" · robinet de purge 3/8" · подключение сливного клапана 3/8".

## R251W

| PRODUCT CODE     | SIZE   | □  | ⊞   |
|------------------|--------|----|-----|
| <b>R251WX022</b> | 3/8"   | 10 | 100 |
| <b>R251WX023</b> | 1/2"   | 10 | 100 |
| <b>R251WX024</b> | 3/4"   | 5  | 50  |
| <b>R251WX025</b> | 1"     | 5  | 25  |
| <b>R251WX026</b> | 1 1/4" | 4  | 20  |

Standard port ball valve, green T handle, chrome plated with reduced percentage of lead. Suitable for sanitary water.

Vanne à sphère nickelée et chromée avec pourcentage réduit de plomb. Poignée papillon verte. Convient pour l'eau potable.

Кран шаровый со стандартным проходом, с зеленой рукояткой, хромированный, с низким содержанием свинца, для питьевой воды.



## R259W

| PRODUCT CODE     | SIZE                | □ | ⊞  |
|------------------|---------------------|---|----|
| <b>R259WX023</b> | 1/2" F x 1/2" M     | 1 | 50 |
| <b>R259WX024</b> | 1/2" F x 3/4" M     | 1 | 50 |
| <b>R259WX025</b> | 3/4" F x 3/4" M     | 1 | 20 |
| <b>R259WX026</b> | 3/4" F x 1" M       | 1 | 20 |
| <b>R259WX027</b> | 1" F x 1" M         | 1 | 20 |
| <b>R259WX028</b> | 1" F x 1 1/4" M     | 1 | 20 |
| <b>R259WX029</b> | 1 1/4" F x 1 1/4" M | 1 | 20 |

Standard port ball valve with tail piece, green T handle, chrome plated with reduced percentage of lead. Suitable for sanitary water.

Vanne à sphère nickelée, démontable. Poignée papillon verte. Chromée avec pourcentage réduit de plomb. Convient pour l'eau potable.

Кран шаровый со стандартным проходом, с зеленой рукояткой - бабочкой, с отводом, хромированный, с низким содержанием свинца, для питьевой воды.



## R253W

| PRODUCT CODE     | SIZE   | □  | ⊞   |
|------------------|--------|----|-----|
| <b>R253WX002</b> | 3/8"   | 10 | 100 |
| <b>R253WX003</b> | 1/2"   | 10 | 100 |
| <b>R253WX004</b> | 3/4"   | 5  | 50  |
| <b>R253WX005</b> | 1"     | 5  | 50  |
| <b>R253WX006</b> | 1 1/4" | 4  | 20  |

Male x male standard port ball valve, green T handle, chrome plated with reduced percentage of lead. Suitable for sanitary water.

Vanne à sphère nickelée mâle x mâle. Poignée papillon verte. Chromée avec pourcentage réduit de plomb. Convient pour l'eau potable.

Кран шаровый со стандартным проходом, с зеленой рукояткой, хромированный, с низким содержанием свинца, для питьевой воды, с наружной резьбой.



## R253WL

| PRODUCT CODE     | SIZE   | □  | ⊞   |
|------------------|--------|----|-----|
| <b>R253WX032</b> | 3/8"   | 10 | 100 |
| <b>R253WX033</b> | 1/2"   | 10 | 100 |
| <b>R253WX034</b> | 3/4"   | 5  | 50  |
| <b>R253WX035</b> | 1"     | 2  | 20  |
| <b>R253WX036</b> | 1 1/4" | 2  | 20  |

Male x male standard port ball valve, green lever handle, chrome plated with reduced percentage of lead. Suitable for sanitary water.

Vanne à sphère nickelée mâle x mâle. Poignée verte. Chromée avec pourcentage réduit de plomb. Convient pour l'eau potable.

Кран шаровый со стандартным проходом, с зеленой рычажной рукояткой, хромированный, с низким содержанием свинца, для питьевой воды, с наружной резьбой.





## R254W

| PRODUCT CODE | SIZE   | □  | ⊞   |
|--------------|--------|----|-----|
| R254WX022    | 3/8"   | 10 | 100 |
| R254WX023    | 1/2"   | 10 | 100 |
| R254WX024    | 3/4"   | 5  | 50  |
| R254WX025    | 1"     | 5  | 50  |
| R254WX026    | 1 1/4" | 4  | 20  |

Male x female standard port ball valve, green T handle, chrome plated with reduced percentage of lead. Suitable for sanitary water.

Vanne à sphère nickelée mâle x femelle. Poignée papillon verte. Chromée avec pourcentage réduit de plomb. Convient pour l'eau potable.

Кран шаровый со стандартным проходом, с зеленой рукояткой, хромированный, с низким содержанием свинца, для питьевой воды, с наружной и внутренней резьбой.



## R254WL

| PRODUCT CODE | SIZE   | □  | ⊞   |
|--------------|--------|----|-----|
| R254WX052    | 3/8"   | 10 | 100 |
| R254WX053    | 1/2"   | 10 | 100 |
| R254WX054    | 3/4"   | 5  | 50  |
| R254WX055    | 1"     | 2  | 20  |
| R254WX056    | 1 1/4" | 2  | 20  |
| R254WX057    | 1 1/2" | 4  | 16  |
| R254WX058    | 2"     | 2  | 10  |

Male x female standard port ball valve, green lever handle, chrome plated with reduced percentage of lead. Suitable for sanitary water.

Vanne à sphère nickelée mâle x femelle. Poignée verte. Chromée avec pourcentage réduit de plomb. Convient pour l'eau potable.

Кран шаровый со стандартным проходом, с зеленой рычажной рукояткой, хромированный, с низким содержанием свинца, для питьевой воды, с наружной и внутренней резьбой.



## R950W

| PRODUCT CODE | SIZE   | □  | ⊞   |
|--------------|--------|----|-----|
| R950WX002    | 3/8"   | 10 | 100 |
| R950WX003    | 1/2"   | 5  | 50  |
| R950WX004    | 3/4"   | 5  | 50  |
| R950WX005    | 1"     | 5  | 25  |
| R950WX006    | 1 1/4" | 4  | 20  |
| R950WX007    | 1 1/2" | 2  | 10  |
| R950WX008    | 2"     | 2  | 10  |

Full port ball valve, compact series, green lever handle nickel plated with reduced percentage of lead. Suitable for sanitary water.

Vanne à sphère, modèle compact, à passage intégral, poignée verte nickelée avec un pourcentage réduit de plomb. Convient pour l'eau potable.

Кран шаровый полнопроходный с шаром DADO, для питьевой воды, усиленная модель, резьба внутренняя/внутренняя, никелированный, ручка - рычаг зеленый.



DADO



## R951W

| PRODUCT CODE | SIZE   | □  | ⊞   |
|--------------|--------|----|-----|
| R951WX002    | 3/8"   | 10 | 100 |
| R951WX003    | 1/2"   | 10 | 100 |
| R951WX004    | 3/4"   | 5  | 50  |
| R951WX005    | 1"     | 5  | 25  |
| R951WX006    | 1 1/4" | 4  | 20  |

Full port ball valve, compact series, green T handle nickel plated with reduced percentage of lead. Suitable for sanitary water.

Vanne à sphère, modèle compact, poignée papillon verte nickelée avec un pourcentage réduit de plomb, à passage intégral. Convient pour l'eau potable.

Кран шаровый полнопроходный с шаром DADO, для питьевой воды, усиленная модель, резьба внутренняя/внутренняя, никелированный, ручка - бабочка зеленая.



DADO



## R250D

| PRODUCT CODE | SIZE   | □  | ⊞   |
|--------------|--------|----|-----|
| R250X001     | 1/4"   | 20 | 200 |
| R250X002     | 3/8"   | 10 | 100 |
| R250X003     | 1/2"   | 10 | 100 |
| R250X004     | 3/4"   | 5  | 50  |
| R250X005     | 1"     | 5  | 25  |
| R250X006     | 1 1/4" | 4  | 20  |
| R250X007     | 1 1/2" | 2  | 10  |
| R250X008     | 2"     | 2  | 10  |
| R250X009     | 2 1/2" | 2  | 6   |
| R250X010     | 3"     | 2  | 4   |
| R250X011     | 4"     | 1  | 2   |

Standard port ball valve, red lever handle, chrome plated.

Vanne à boisseau sphérique, passage standard, poignée rouge, chromée.

Кран шаровый, резьба внутренняя/внутренняя, стандартный проход, хромированный, ручка - рычаг красный.



## R250DS

| PRODUCT CODE | SIZE   | □ | ⊞  |
|--------------|--------|---|----|
| R250SX003    | 1/2"   | 5 | 50 |
| R250SX004    | 3/4"   | 5 | 50 |
| R250SX005    | 1"     | 5 | 25 |
| R250SX006    | 1 1/4" | 4 | 20 |
| R250SX007    | 1 1/2" | 2 | 10 |
| R250SX008    | 2"     | 2 | 10 |

Standard port ball valve with drain tap, red lever handle, chrome plated.

Vanne à sphère nickelée et chromée à passage standard avec robinet de vidange rouge.

Кран шаровый со сливом, резьба внутренняя/внутренняя, стандартный проход, хромированный, ручка - рычаг красный.

### NOTES

1/2" - 3/4" - 1": drain tap 1/4" · robinet de purge 1/4" · подключение сливного крана 1/4".

1 1/4" - 1 1/2" - 2": Drain tap 3/8" · robinet de purge 3/8" · подсоединение сливного клапана 3/8".





## R251D

| PRODUCT CODE | SIZE   | □  | ⊞   |
|--------------|--------|----|-----|
| R251X001     | 1/4"   | 20 | 200 |
| R251X002     | 3/8"   | 10 | 100 |
| R251X003     | 1/2"   | 10 | 100 |
| R251X004     | 3/4"   | 5  | 50  |
| R251X005     | 1"     | 5  | 25  |
| R251X006     | 1 1/4" | 5  | 25  |



Standard port ball valve, red lever handle, chrome plated.

Vanne à boisseau sphérique, passage standard, poignée papillon rouge, chromée.

Кран шаровый, резьба внутренняя/внутренняя, стандартный проход, хромированный, ручка - бабочка красная.

## R251T

chrome plated - chromé - хромированный

| PRODUCT CODE | SIZE | □ | ⊞  |
|--------------|------|---|----|
| R251TX004    | 3/4" | 5 | 50 |
| R251TX005    | 1"   | 5 | 25 |

brass finish - laiton - нехромированный

| PRODUCT CODE | SIZE | □ | ⊞  |
|--------------|------|---|----|
| R251TY004    | 3/4" | 5 | 50 |
| R251TY005    | 1"   | 5 | 25 |



Standard port ball valve, with sensor connection M10 female connection.

Vanne à sphère avec prise de pression M10 raccord femelle.

Кран шаровый со штуцером для зонда M10, резьба внутренняя/внутренняя, стандартный проход, ручка - бабочка красная.

## R253D

| PRODUCT CODE | SIZE   | □  | ⊞   |
|--------------|--------|----|-----|
| R253X002     | 3/8"   | 10 | 100 |
| R253X003     | 1/2"   | 10 | 100 |
| R253X004     | 3/4"   | 5  | 50  |
| R253X005     | 1"     | 5  | 50  |
| R253X006     | 1 1/4" | 4  | 20  |



Male x male standard port ball valve, red T handle, chrome plated.

Vanne à boisseau sphérique mâle mâle, passage standard, poignée papillon rouge, chromée.

Кран шаровый, резьба наружная/наружная, стандартный проход, хромированный, ручка - бабочка красная.

## R254D

| PRODUCT CODE | SIZE   | □  | ⊞   |
|--------------|--------|----|-----|
| R254X001     | 1/4"   | 20 | 200 |
| R254X002     | 3/8"   | 10 | 100 |
| R254X003     | 1/2"   | 10 | 100 |
| R254X004     | 3/4"   | 5  | 50  |
| R254X005     | 1"     | 5  | 50  |
| R254X006     | 1 1/4" | 4  | 20  |



Male x female standard port ball valve, red T handle, chrome plated.

Vanne à boisseau sphérique mâle femelle, passage standard, poignée papillon rouge, chromée.

Кран шаровый, резьба внутренняя/наружная, стандартный проход, хромированный, ручка - бабочка красная.

## R251S

| PRODUCT CODE | SIZE | □ | ⊞  |
|--------------|------|---|----|
| R251SX003    | 1/2" | 5 | 50 |
| R251SX004    | 3/4" | 5 | 50 |
| R251SX005    | 1"   | 5 | 25 |



Standard port ball valve with drain tap, red T handle, chrome plated.

Vanne à sphère passage standard avec robinet de vidange, nickelée chromée.

Кран шаровый со сливом, резьба внутренняя/внутренняя, стандартный проход, хромированный, ручка - бабочка красная.

NOTES

1/2" - 3/4" - 1": drain tap 1/4" - robinet de purge 1/4" - сливной кран 1/4".

## R251TH

| PRODUCT CODE | SIZE   | □  | ⊞   |
|--------------|--------|----|-----|
| R251X052     | 3/8"   | 10 | -   |
| R251X053     | 1/2"   | 10 | 100 |
| R251X054     | 3/4"   | 5  | 50  |
| R251X055     | 1"     | 5  | 25  |
| R251X056     | 1 1/4" | 4  | 20  |
| R251X057     | 1 1/2" | 1  | -   |
| R251X058     | 2"     | 1  | -   |



Standard port chrome plated ball valve with extended handle, suitable for installations with high insulating thickness.

Vanne à sphère chromée avec poignée réhaussée, appropriée pour les installations avec une importante épaisseur d'isolation.

Кран шаровый, резьба внутренняя/внутренняя, стандартный проход, хромированный, ручка пластиковая удлиненная для труб с термоизоляцией.

## R253DL

| PRODUCT CODE | SIZE   | □  | ⊞   |
|--------------|--------|----|-----|
| R253LX002    | 3/8"   | 10 | 100 |
| R253LX003    | 1/2"   | 10 | 100 |
| R253LX004    | 3/4"   | 5  | 50  |
| R253LX005    | 1"     | 2  | 20  |
| R253LX006    | 1 1/4" | 2  | 20  |



Male x male standard port ball valve, red lever handle, chrome plated.

Vanne à boisseau sphérique mâle mâle, passage standard, poignée rouge, chromée.

Кран шаровый, резьба наружная/наружная, стандартный проход, хромированный, ручка - рычаг красный.

## R254DL

| PRODUCT CODE | SIZE   | □  | ⊞   |
|--------------|--------|----|-----|
| R254LX001    | 1/4"   | 20 | 200 |
| R254LX002    | 3/8"   | 10 | 100 |
| R254LX003    | 1/2"   | 10 | 100 |
| R254LX004    | 3/4"   | 5  | 50  |
| R254LX005    | 1"     | 2  | 20  |
| R254LX006    | 1 1/4" | 2  | 20  |
| R254LX007    | 1 1/2" | 2  | 10  |
| R254LX008    | 2"     | 2  | 10  |



Male x female standard port ball valve, red lever handle, chrome plated.

Vanne à boisseau sphérique mâle femelle, passage standard, poignée rouge, chromée.

Кран шаровый, резьба внутренняя/наружная, стандартный проход, хромированный, ручка - рычаг красный.

## R259D

### chrome plated - chromé - хромированный

| PRODUCT CODE | SIZE                | □  | ⊞  |
|--------------|---------------------|----|----|
| R259X003     | 1/2" F x 1/2" M     | 25 | 50 |
| R259X004     | 1/2" F x 3/4" M     | 25 | 50 |
| R259X005     | 3/4" F x 3/4" M     | 10 | 20 |
| R259X006     | 3/4" F x 1" M       | 10 | 20 |
| R259X007     | 1" F x 1" M         | 10 | 20 |
| R259X008     | 1" F x 1 1/4" M     | 10 | 20 |
| R259X009     | 1 1/4" F x 1 1/4" M | 10 | 20 |



### brass finish - laiton - нехромированный

| PRODUCT CODE | SIZE                | □  | ⊞  |
|--------------|---------------------|----|----|
| R259Y003     | 1/2" F x 1/2" M     | 25 | 50 |
| R259Y005     | 3/4" F x 3/4" M     | 10 | 20 |
| R259Y006     | 3/4" F x 1" M       | 10 | 20 |
| R259Y007     | 1" F x 1" M         | 10 | 20 |
| R259Y008     | 1" F x 1 1/4" M     | 10 | 20 |
| R259Y009     | 1 1/4" F x 1 1/4" M | 10 | 20 |

Standard port ball valve with tail piece, red T handle, chrome plated.

Vanne à sphère nickelée et chromée, démontable.

Кран шаровый с отводом, резьба внутренняя/наружная, стандартный проход, хромированный, ручка - бабочка красная.

## R259DST

| PRODUCT CODE | SIZE        | □ | ⊞  |
|--------------|-------------|---|----|
| R259SY067    | 1" F x 1" M | 1 | 10 |

Couple ball valves, male-female connections, red T handle, thermometer (R540 series) and drain tap.

Vanne à boisseau sphérique, raccordement femelle x raccord à 3 pièces, manette papillon et thermomètre R540Y015 3/8" intégré. Passage standard.

Комплект для коллекторов для теплого пола: 2 шаровых крана 1"x1", с отводом и 2 термометра R540Y015.

### NOTES

Drain tap 3/8" · robinet de purge 3/8" · сливной кран 3/8".



## R258D

| PRODUCT CODE | SIZE | □  | ⊞   |
|--------------|------|----|-----|
| R258Y002     | Ø15  | 10 | 100 |
| R258Y004     | Ø18  | 10 | 100 |
| R258Y005     | Ø22  | 6  | 60  |
| R258Y006     | Ø28  | 6  | 30  |
| R258Y007     | Ø35  | 4  | 20  |



Standard port ball valve with solder end brass finish.

Vanne à sphère passage standard avec embout à souder, finition brut de laiton.

Кран шаровый со стандартным проходом, с отводами под пайку, нехромированный.

## R254P

### chrome plated - chromé - хромированный

| PRODUCT CODE | SIZE              | □ | ⊞  |
|--------------|-------------------|---|----|
| R254PX004    | 3/4" M x 3/4" nut | 5 | 50 |

### brass finish - laiton - нехромированный

| PRODUCT CODE | SIZE              | □ | ⊞  |
|--------------|-------------------|---|----|
| R254PY003    | 1/2" M x 3/4" nut | 5 | 50 |
| R254PY004    | 3/4" M x 3/4" nut | 0 | -  |

Ball valve male-female with meterconnection, brass finish.

Vanne à sphère à écrou prisonnier.

Кран шаровой с наружной / внутренней резьбой, с отводом с накидной гайкой для счетчиков.



## R259DS

| PRODUCT CODE | SIZE                | □  | ⊞  |
|--------------|---------------------|----|----|
| R259SX003    | 1/2" F x 1/2" M     | 25 | 50 |
| R259SX004    | 1/2" F x 3/4" M     | 25 | 50 |
| R259SX005    | 3/4" F x 3/4" M     | 10 | 20 |
| R259SX006    | 3/4" F x 1" M       | 10 | 20 |
| R259SX007    | 1" F x 1" M         | 10 | 20 |
| R259SX008    | 1" F x 1 1/4" M     | 10 | 20 |
| R259SX009    | 1 1/4" F x 1 1/4" M | 10 | 20 |

Standard port ball valve with tail piece and drain tap, red T handle, chrome plated.

Vanne à purge nickelée et chromée, douille étanche, démontable, poignée papillon rouge.

Кран шаровый с отводом и сливом, резьба внутренняя/наружная, стандартный проход, хромированный, ручка - бабочка красная.

### NOTES

1/2" - 3/4" - 1": drain tap 1/4" · robinet de purge 1/4" подключение сливного крана 1/4".

1 1/4": drain tap 3/8" · robinet de purge 3/8" подключение сливного крана 3/8".



## R259T

| PRODUCT CODE | SIZE            | □ | ⊞  |
|--------------|-----------------|---|----|
| R259TY005    | 3/4" F x 3/4" M | 5 | 25 |
| R259TY006    | 3/4" F x 1" M   | 2 | 20 |
| R259TY007    | 1" F x 1" M     | 2 | 20 |

Standard port ball valve, brass finish with tail piece and sensor connection M10, female connection, red T handle.

Vanne à sphère, laiton, démontable et prise de pression M10, raccord femelle, poignée papillon rouge.

Кран шаровый, с отводом, резьба внутренняя/наружная, стандартный проход, ручка - бабочка красная.



## R258CC

| PRODUCT CODE | SIZE      | □ | ⊞  |
|--------------|-----------|---|----|
| R258CX002    | Ø15 x Ø15 | 5 | 50 |
| R258CX005    | Ø22 x Ø22 | 5 | 50 |
| R258CX006    | Ø28 x Ø28 | 6 | 30 |

Standard port ball valve with compression ends, red lever handle, chrome plated.

Vanne à sphère chromée avec raccords.

Кран шаровой со стандартным проходом, с обжимными переходниками для подсоединения металлической трубы, с накидными гайками, с красной рычажной рукояткой.



## R251P

### chrome plated - chromé - хромированный

| PRODUCT CODE | SIZE              | □ | ⊞  |
|--------------|-------------------|---|----|
| R251PX003    | 1/2" F x 3/4" nut | 5 | 50 |
| R251PX004    | 3/4" F x 3/4" nut | 5 | 50 |
| R251PX005    | 3/4" F x 1" nut   | 5 | 50 |
| R251PX006    | 1" F x 1" nut     | 5 | 25 |

### brass finish - laiton - нехромированный

| PRODUCT CODE | SIZE              | □ | ⊞  |
|--------------|-------------------|---|----|
| R251PY003    | 1/2" F x 3/4" nut | 5 | 50 |
| R251PY004    | 3/4" F x 3/4" nut | 5 | 50 |
| R251PY005    | 3/4" F x 1" nut   | 5 | 50 |
| R251PY006    | 1" F x 1" nut     | 5 | 25 |

Ball valve female-female with meterconnection, brass finish.

Vanne à sphère à écrou prisonnier.

Кран шаровый с внутренней резьбой, с отводом с накидной гайкой для счетчиков.



## R285L

| PRODUCT CODE                 | SIZE              | ☐  | ☒   |
|------------------------------|-------------------|----|-----|
| <b>R285LY001</b>             | 1" F x 1 1/2"     | 4  | 40  |
| <b>R285LY002</b>             | 1 1/4" F x 1 1/2" | 4  | 40  |
| <b>R285LY003</b>             | 1 1/4" F x 2"     | 4  | 20  |
| <b>Nut - Calotte - Гайка</b> |                   |    |     |
| <b>P18LY007</b>              | 1 1/2"            | 20 | 200 |

Pump ball valve with extended stem, female x flanged connection, brass finish, lever handle.

Vanne à boisseau sphérique pour circulateur avec poignée réhaussée.

Шаровый кран с выводом для насоса, с внутренней резьбой и фланцевым соединением, с рычажной рукояткой на удлиненном штоке, нехроми рованный.

### NOTES

To be completed with P18LY007 nut.

À compléter avec écrou P18LY007.

Гайка P18LY007 заказывается дополнительно.



P18LY007



## R285

| PRODUCT CODE                 | SIZE              | ☐  | ☒   |
|------------------------------|-------------------|----|-----|
| <b>R285Y001</b>              | 1" F x 1 1/2"     | 4  | 40  |
| <b>R285Y002</b>              | 1 1/4" F x 1 1/2" | 4  | 20  |
| <b>R285Y003</b>              | 1 1/4" F x 2"     | 4  | 20  |
| <b>Nut - Calotte - Гайка</b> |                   |    |     |
| <b>P18LY007</b>              | 1 1/2"            | 20 | 200 |

Pump ball valve with extended stem, female x flanged connection, brass finish, T handle.

Vanne à boisseau sphérique laiton spéciale pour circulateur avec poignée rehaussée (possibilité de mettre le clapet anti retour R288).

Шаровый кран с выводом для насоса, с внутренней резьбой и фланцевым соединением, с рукояткой на удлиненном штоке, нехромированный.

### NOTES

To be completed with P18LY007 nut.

À compléter avec écrou P18LY007.

Гайка P18LY007 заказывается дополнительно.



P18LY007



## R287

| PRODUCT CODE    | SIZE            | ☐ | ☒  |
|-----------------|-----------------|---|----|
| <b>R287Y005</b> | 1" x 1 1/2" nut | 4 | 20 |

Ball valve with 1/2" connection for temperature gauge R540 and 18 mm compression connection to suit differential unit.

Vanne à sphère avec raccord 1/2" pour thermomètre R540, alésage 18mm pour vanne différentielle.

Шаровый кран с выводом 1/2" для термометра R540 и 18-миллиметровым выводом подключения доп. устройств.



## R752

| PRODUCT CODE    | SIZE              | ☐ | ☒  |
|-----------------|-------------------|---|----|
| <b>R752X003</b> | 1/2" F x 3/4" nut | 5 | 50 |
| <b>R752X005</b> | 3/4" F x 1" nut   | 5 | 25 |

Ball valve with adjustable connection.

Vanne à sphère pour compteur d'eau démontable écrou plombable et douille télescopique.

Кран шаровый с регулируемым отводом, с накидной гайкой, для счетчиков, с внутренней резьбой.



## R287M

| PRODUCT CODE     | SIZE            | ☐ | ☒  |
|------------------|-----------------|---|----|
| <b>R287MY005</b> | 1" x 1 1/2" nut | 1 | 10 |

Couple of ball valves with female-female connections with nut. Composed by: ball valve R287 1", non return valve R288 1", thermometers R540 1/2", plugs R92 1/2".

Vanne à sphère 1" R287, clapet anti retour 1" R288, bouchons 1/2" R92 et thermomètre 1/2" R540.

Комплект, состоящий из: шаровых клапанов R287 1", обратных клапанов R288 1", термометров R540 1/2", пробок R92 1/2".



## R252

| PRODUCT CODE    | SIZE            | ☐ | ☒  |
|-----------------|-----------------|---|----|
| <b>R252Y001</b> | 1" F x 1 1/2" F | 2 | 50 |
| <b>R252Y002</b> | 1 1/4" F x 2" F | 2 | 20 |
| <b>R252Y003</b> | 1 1/2" x 22     | 2 | 50 |
| <b>R252Y004</b> | 1 1/2" x 28     | 2 | 50 |

Isolating pump valve, brass finish.

Vanne laiton spéciale pour circulateur.

Фитинг для подключения циркуляционного насоса, с встроенным шаровым краном.



## R602

| PRODUCT CODE    | SIZE | ☐  | ☒   |
|-----------------|------|----|-----|
| <b>R602Y002</b> | 3/8" | 10 | 100 |
| <b>R602Y003</b> | 1/2" | 10 | 100 |
| <b>R602Y004</b> | 3/4" | 5  | 50  |

Gas ball valve female x female connections, lever handle, brass finish.

Robinet laiton à boisseau sphérique raccord femelle x femelle, poignée droite.

Кран шаровый с внутренней резьбой, нехромированный, рычажной рукояткой.



## > BALL VALVES FOR GAS USE

### VANNES À BOISSEAU SPHÉRIQUE POUR L'UTILISE DE GAS

### ШАРОВЫЕ КРАНЫ ДЛЯ ГАЗА

#### R950

| PRODUCT CODE | SIZE   | □  | ⊞   |
|--------------|--------|----|-----|
| R950X001     | 1/4"   | 20 | 200 |
| R950X002     | 3/8"   | 10 | 100 |
| R950X003     | 1/2"   | 5  | 50  |
| R950X004     | 3/4"   | 5  | 50  |
| R950X005     | 1"     | 5  | 25  |
| R950X006     | 1 1/4" | 4  | 20  |
| R950X007     | 1 1/2" | 2  | 10  |
| R950X008     | 2"     | 2  | 10  |



DADO

Full port DADO ball valve, heavy series, nickel plated, yellow level handle.

Vanne à boisseau sphérique DADO, modèle lourd, passage intégral, poignée jaune, nickelée.

Кран шаровый полнопроходный с шаром DADO, усиленная модель, резьба внутренняя/внутренняя, никелированный, ручка - рычаг жёлтый.



#### R951

| PRODUCT CODE | SIZE   | □  | ⊞   |
|--------------|--------|----|-----|
| R951X001     | 1/4"   | 20 | 200 |
| R951X002     | 3/8"   | 10 | 100 |
| R951X003     | 1/2"   | 10 | 100 |
| R951X004     | 3/4"   | 5  | 50  |
| R951X005     | 1"     | 5  | 25  |
| R951X006     | 1 1/4" | 4  | 20  |



DADO

Full port DADO ball valve, heavy series, nickel plated, yellow T handle.

Vanne à boisseau sphérique DADO, modèle lourd, passage intégral, papillon jaune, nickelée.

Кран шаровый полнопроходный с шаром DADO, усиленная модель, резьба внутренняя/внутренняя, никелированный, ручка - бабочка жёлтая.



#### R910

| PRODUCT CODE | SIZE   | □  | ⊞   |
|--------------|--------|----|-----|
| R910X002     | 3/8"   | 10 | 100 |
| R910X003     | 1/2"   | 10 | 100 |
| R910X004     | 3/4"   | 5  | 50  |
| R910X005     | 1"     | 5  | 25  |
| R910X006     | 1 1/4" | 4  | 20  |
| R910X007     | 1 1/2" | 2  | 10  |
| R910X008     | 2"     | 2  | 10  |
| R910X009     | 2 1/2" | 2  | 4   |
| R910X010     | 3"     | 1  | 2   |
| R910X011     | 4"     | 1  | 2   |



DADO

Full port DADO ball valve, compact pattern, yellow lever handle, nickel plated.

Vanne à boisseau sphérique DADO, passage intégral, poignée jaune, nickelée.

Кран шаровый полнопроходный с шаром DADO, резьба внутренняя/внутренняя, никелированный, ручка - рычаг жёлтый.



#### R911

| PRODUCT CODE | SIZE   | □  | ⊞   |
|--------------|--------|----|-----|
| R911X002     | 3/8"   | 10 | 100 |
| R911X003     | 1/2"   | 10 | 100 |
| R911X004     | 3/4"   | 5  | 50  |
| R911X005     | 1"     | 5  | 25  |
| R911X006     | 1 1/4" | 4  | 20  |



DADO

Full port DADO ball valve, compact pattern, nickel plated, yellow T handle.

Vanne à boisseau sphérique DADO, passage intégral, papillon jaune, nickelée.

Кран шаровый полнопроходный с шаром DADO, резьба внутренняя/внутренняя, никелированный, ручка - бабочка жёлтая.



#### R914L

| PRODUCT CODE | SIZE   | □  | ⊞   |
|--------------|--------|----|-----|
| R914LX001    | 1/4"   | 20 | 200 |
| R914LX002    | 3/8"   | 10 | 100 |
| R914LX003    | 1/2"   | 5  | 50  |
| R914LX004    | 3/4"   | 5  | 50  |
| R914LX005    | 1"     | 2  | 20  |
| R914LX006    | 1 1/4" | 2  | 20  |
| R914LX007    | 1 1/2" | 2  | 10  |
| R914LX008    | 2"     | 2  | 10  |



DADO

Male x female full port DADO ball valve, compact pattern, yellow lever handle, nickel plated.

Vanne à boisseau sphérique DADO mâle femelle, passage intégral, poignée jaune, nickelée.

Кран шаровый полнопроходный с шаром DADO, резьба внутренняя/наружная, никелированный, ручка - рычаг жёлтый.



#### R914

| PRODUCT CODE | SIZE   | □  | ⊞   |
|--------------|--------|----|-----|
| R914X001     | 1/4"   | 20 | 200 |
| R914X002     | 3/8"   | 10 | 100 |
| R914X003     | 1/2"   | 10 | 100 |
| R914X004     | 3/4"   | 5  | 50  |
| R914X005     | 1"     | 5  | 25  |
| R914X006     | 1 1/4" | 2  | 20  |



DADO

Male x female, full port DADO ball valve, compact pattern, yellow T handle, nickel plated.

Vanne à boisseau sphérique DADO mâle femelle, nickelée à passage intégral, avec papillon.

Кран шаровый полнопроходный с шаром DADO, резьба внутренняя/наружная, никелированный, ручка - бабочка жёлтая.



#### R850

| PRODUCT CODE | SIZE   | □  | ⊞   |
|--------------|--------|----|-----|
| R850X001     | 1/4"   | 20 | 200 |
| R850X002     | 3/8"   | 10 | 100 |
| R850X003     | 1/2"   | 10 | 100 |
| R850X004     | 3/4"   | 5  | 50  |
| R850X005     | 1"     | 5  | 25  |
| R850X006     | 1 1/4" | 4  | 20  |
| R850X007     | 1 1/2" | 4  | 20  |
| R850X008     | 2"     | 2  | 10  |



Full port ball valve, yellow lever handle, chrome plated.

Vanne à boisseau sphérique, passage intégral, poignée jaune, chromée.

Кран шаровый полнопроходный, резьба внутренняя/внутренняя, хромированный, ручка - рычаг жёлтый.



## R851

| PRODUCT CODE | SIZE   | □  | ⊞   |
|--------------|--------|----|-----|
| R851X001     | 1/4"   | 20 | 200 |
| R851X002     | 3/8"   | 10 | 100 |
| R851X003     | 1/2"   | 10 | 100 |
| R851X004     | 3/4"   | 5  | 50  |
| R851X005     | 1"     | 5  | 50  |
| R851X006     | 1 1/4" | 5  | 25  |

Full port, chrome plated, ball valve with yellow T handle and female connections.

Vanne à boisseau sphérique, passage intégral, poignée papillon jaune, chromée.

Кран шаровый полнопроходный, резьба внутренняя/внутренняя, хромированный, ручка - бабочка жёлтая.



## R850V

| PRODUCT CODE | SIZE | □ | ⊞  |
|--------------|------|---|----|
| R850VY103    | Ø15  | 5 | 50 |
| R850VY104    | Ø22  | 5 | 25 |
| R850VY105    | Ø28  | 3 | 18 |
| R850VY106    | Ø35  | 2 | 12 |
| R850VY107    | Ø42  | 2 | 10 |
| R850VY108    | Ø54  | 2 | 8  |

Brass-finished ball valve, press-fitting connections, with yellow O-ring according to EN 549 and EN 682 standards, for gas and hydrocarbon fluids distribution systems, and yellow lever handle. Full port.

Pressable with "V", "SA" or "M" profile tongs.

Vanne à sphère non chromée, raccordement à sertir avec joint Oring jaune conforme à la norme EN549 et EN682 pour installation gaz et hydrocarbure fluide, poignée jaune. Passage intégral. Utiliser le profil en "V".

Кран шаровой полнопроходной, соединения под пресс, с желтым уплотнительным кольцом, соответствует EN549 и EN682 для газовых систем и углеводородных жидкостей, рычаг желтый, нехромированный.

Использовать профиль "V".



## R790

| PRODUCT CODE | SIZE              | □ | ⊞  |
|--------------|-------------------|---|----|
| R790Y004     | 3/4" F x 1 1/4" M | 1 | 25 |
| R790Y005     | 1" F x 1 1/2" M   | 1 | 25 |

Brass finish ball valve, female and male connection for nut and tail piece, preset for press fitting connection in order to check the sealing of gas distribution inner systems (UNI-CIG 7129).

Vanne à sphère non chromée, raccordements femelle x mâle pour nipple et écrou, prédisposée d'un raccordement prise de pression pour vérifier la tenue dans les installations internes pour la distribution de gaz (UNI-CIG 7129).

A compléter avec le kit de raccordement avec filet femelle R795FY004 (3/4") et R795FY005 (1") ou avec le kit de raccordement à sertir RP pour tube cuivre R795VY004 (3/4") et R795VY005 (1").

Кран шаровый нехромированный, соединения внутренняя резьба и наружная для накидной гайки, предусмотрен монтаж штуцера для замера значения давления для проверки герметичности внутридомовых систем подачи газа (UNI-CIG 7129).

### NOTES

To be completed with · À compléter avec · Дополнительные принадлежности:

- R795FY004 (3/4") or R795FY05 (1") for female connection. · R795FY004 (3/4") ou R795FY05 (1") pour raccordement femelle. · Докомплектовать соединителем с наружной резьбой R795FY004 (3/4") или R795FY005 (1").
- R795MY004 (3/4") or R795MY05 (1") for male connection. · R795MY004 (3/4") ou R795MY05 (1") pour raccordement mâle. · Докомплектовать соединителем с наружной резьбой R795MY004 (3/4") или R795MY005 (1").
- R795VY004 (3/4") or R795VY05 (1") for press connection. · R795VY004 (3/4") ou R795VY05 (1") pour raccordement à presser. · Докомплектовать соединителем для пресс соединения R795VY004 (3/4") или R795VY005 (1").



## R792

| PRODUCT CODE | SIZE              | □ | ⊞  |
|--------------|-------------------|---|----|
| R792Y004     | 3/4" F x 1 1/4" M | 1 | 25 |
| R792Y005     | 1" F x 1 1/2" M   | 1 | 25 |

Brass finish ball valve, angle version, 3/4" and 1" female threads, 1 1/4" and 1 1/2" male for the connection to nut and tail piece, with prearrangement for pressure outlet, to check the tightness in the internal systems for the distribution of gas (UNI-CIG 7129). Yellow T handle.

Robinet à boisseau sphérique laiton, équerre, filet femelle à 3/4" et 1", filet mâle 1 1/4" et 1 1/2" pour le raccordement au bouchon de remplissage et à la douille, avec prédisposition pour prise de pression afin de vérifier l'étanchéité du système interne de distribution du gaz (UNI-CIG 7129), équipé d'un verrouillage de sécurité avec clé. Poignée papillon jaune.

Кран шаровый нехромированный, угловой, соединения внутренняя резьба 3/4" и 1", наружная резьба 1 1/4" и 1 1/2" для подключения разборного отвода, с возможностью монтажа штуцера для измерения значения давления с целью контроля герметичности в системах внутридомового газоснабжения (UNI-CIG 7129) ручка бабочка жёлтого цвета.

### NOTES

To be completed with · À compléter avec · Дополнительные принадлежности:

- R795FY004 (3/4") or R795FY05 (1") for female connection. · R795FY004 (3/4") ou R795FY05 (1") pour raccordement femelle. · Докомплектовать соединителем с наружной резьбой R795FY004 (3/4") или R795FY005 (1").
- R795MY004 (3/4") or R795MY05 (1") for male connection. · R795MY004 (3/4") ou R795MY05 (1") pour raccordement mâle. · Докомплектовать соединителем с наружной резьбой R795MY004 (3/4") или R795MY005 (1").
- R795VY004 (3/4") or R795VY05 (1") for press connection. · R795VY004 (3/4") ou R795VY05 (1") pour raccordement à presser. · Докомплектовать соединителем для пресс соединения R795VY004 (3/4") или R795VY005 (1").



## R790B

| PRODUCT CODE | SIZE              | □ | ⊞  |
|--------------|-------------------|---|----|
| R790BY004    | 3/4" F x 1 1/4" M | 1 | 25 |

Brass finish ball valve, straight, 3/4" and 1" female threads, 1 1/4" and 1 1/2" male for the connection to nut and tail piece, with pressure outlet to check the tightness in the internal systems for the distribution of gas (UNI-CIG 7129), equipped with safety closure with key. Yellow T handle.

Robinet à boisseau sphérique non chromé, droit, filet femelle à 3/4" et 1", filet mâle 1 1/4" et 1 1/2" pour le raccordement au bouchon de remplissage et à la douille, avec prise de pression pour vérifier l'étanchéité du système interne de distribution du gaz (UNI-CIG 7129), équipé d'un verrouillage de sécurité avec clé. Poignée papillon jaune.

Кран шаровой нехромированный, прямой, соединения внутренняя резьба 3/4" и 1", наружная резьба 1 1/4" и 1 1/2" для подключения разборного отвода, со штуцером для измерения значения давления с целью контроля герметичности в системах внутридомового газоснабжения (UNI-CIG 7129), оснащен замком с ключом. Ручка бабочка жёлтого цвета.

### NOTES

To be completed with · À compléter avec · Дополнительные принадлежности:

- R795FY004 (3/4") or R795FY05 (1") for female connection. · R795FY004 (3/4") ou R795FY05 (1") pour raccordement femelle. · Докомплектовать соединителем с наружной резьбой R795FY004 (3/4") или R795FY005 (1").
- R795MY004 (3/4") or R795MY05 (1") for male connection. · R795MY004 (3/4") ou R795MY05 (1") pour raccordement mâle. · Докомплектовать соединителем с наружной резьбой R795MY004 (3/4") или R795MY005 (1").
- R795VY004 (3/4") or R795VY05 (1") for press connection. · R795VY004 (3/4") ou R795VY05 (1") pour raccordement à presser. · Докомплектовать соединителем для пресс соединения R795VY004 (3/4") или R795VY005 (1").



## R792B

| PRODUCT CODE     | SIZE              | □ | ⊞  |
|------------------|-------------------|---|----|
| <b>R792BY004</b> | 3/4" F x 1 1/4" M | 1 | 25 |
| <b>R792BY005</b> | 1" F x 1 1/2" M   | 1 | 25 |

Brass finish ball valve, angle version, 3/4" and 1" female connections, 1 1/4" and 1 1/2" male for the connection to nut and tail piece, with pressure outlet to check the tightness of the internal systems for the distribution of gas (UNI-CIG 7129), equipped with safety closure with key. Yellow T handle.

Robinet à boisseau sphérique en laiton, modèle équerre, raccord femelle 3/4" et 1", mâle 1 1/4" et 1 1/2" pour le raccordement au bouchon de remplissage et à la douille, avec test de pression pour vérifier l'étanchéité des systèmes internes de distribution de gaz (UNI-CIG 7129), équipé d'une serrure de sécurité avec la clé. Poignée papillon jaune.

Кран шаровой нехромированный, угловой, соединения внутренняя резьба 3/4" и 1", наружная резьба 1 1/4" и 1 1/2" для подключения разборного отвода, со штуцером для измерения значения давления с целью контроля герметичности в системах внутридомового газоснабжения (UNI-CIG 7129), оснащена замком с ключом. Т-образная ручка жёлтого цвета.

### NOTES

- To be completed with · À compléter avec · Дополнительные принадлежности:
- R795FY004 (3/4") or R795FY005 (1") for female connection. · R795FY004 (3/4") ou R795FY005 (1") pour raccordement femelle. · Докомплектовать соединителем с наружной резьбой R795FY004 (3/4") или R795FY005 (1").
  - R795MY004 (3/4") or R795MY005 (1") for male connection. · R795MY004 (3/4") ou R795MY005 (1") pour raccordement mâle. · Докомплектовать соединителем с наружной резьбой R795MY004 (3/4") или R795MY005 (1").
  - R795VY004 (3/4") or R795VY005 (1") for press connection. · R795VY004 (3/4") ou R795VY005 (1") pour raccordement à presser. · Докомплектовать соединителем для пресс соединения R795VY004 (3/4") или R795VY005 (1").



## R795V

| PRODUCT CODE     | SIZE             | □ | ⊞  |
|------------------|------------------|---|----|
| <b>R795VY004</b> | Ø22 x 1 1/4" nut | 1 | 50 |
| <b>R795VY005</b> | Ø28 x 1 1/2" nut | 1 | 50 |

Connection kit for R790, R790B, R792, R792B with R795VY004 (3/4") and R795VY005 (1"). RP mechanical pressure connection for copper pipe.

Kit de raccord pour R790, R790B, R792, R792B avec R795VY004 (3/4") et R795VY005 (1"). Raccordement RP pour tuyau en cuivre.

Комплект подключения для R790, R790B, R792, R792B с пресс-соединением RP для медной трубы R795VY004 (3/4") и R795VY005 (1").



## P790-1

| PRODUCT CODE    | SIZE   | □ | ⊞  |
|-----------------|--------|---|----|
| <b>P790Y001</b> | 1/4" M | 1 | 50 |

Pressure outlet with quick connection and rubber protection.

Prise de pression avec raccord rapide et la protection caoutchouc.

Штуцер для измерения значения давления с быстросъёмным соединением и резиновой защитной втулкой.



### NOTES

The pressure outlet inclusive of protection cap (P790Y001) shall be assembled on Giacomini ball valve for gas systems, that with reference to UNI 7129-1:2008 standard, shall be installed as starting point and shut-off device. The pressure outlet permits to carry out the tightness test as expected by the UNI 11137-1 standard and the prevention of dangerous domestic incidents caused by leakage or microleakage.

La sortie de pression comprenant le bouchon de protection (P790Y001) est à assembler sur la vanne à bille Giacomini pour les systèmes à gaz, qui en référence à la norme UNI 7129-1:2008 standard, est à installer comme point de départ et dispositif d'arrêt. La sortie de pression permet de mener l'essai d'étanchéité conformément à la norme UNI 11137-1 et la prévention d'incidents domestiques graves provoqués par les fuites ou les micro-fuites.

Штуцер давления, включающий защитный колпачок (P790Y001), монтируется на шаровой кран Giacomini для газовых систем, в соответствии со стандартом UNI 7129-1:2008, устанавливается в качестве начальной точки и отсечного устройства. Штуцер давления позволяет выполнять испытание на герметичность в соответствии со стандартом UNI 11137-1 и предупреждает опасные бытовые проблемы, обусловленные утечками или микроутечками.

## R795F

| PRODUCT CODE     | SIZE                | □ | ⊞  |
|------------------|---------------------|---|----|
| <b>R795FY004</b> | 3/4" F x 1 1/4" nut | 1 | 50 |
| <b>R795FY005</b> | 1" F x 1 1/2" nut   | 1 | 50 |

Connection kit for R790, R790B, R792, R792B with female threaded connection R795FY004 (3/4") and R795FY005 (1").

Kit de connexion pour R790, R790B, R792, R792B avec filetage intérieur R795FY004 (3/4") et R795FY005 (1").

Комплект подключения для R790, R790B, R792, R792B с резьбовым внутренним соединением R795FY004 (3/4") и R795FY005 (1").



## R795M

| PRODUCT CODE     | SIZE                | □ | ⊞  |
|------------------|---------------------|---|----|
| <b>R795MY004</b> | 3/4" F x 1 1/4" nut | 1 | 50 |
| <b>R795MY005</b> | 1" F x 1 1/2" nut   | 1 | 50 |

Connection kit for R790, R790B, R792, R792B with male threaded connection R795MY004 (3/4") and R795MY005 (1").

Kit de connexion pour R790, R790B, R792, R792B fileté R795MY004 (3/4") et R795MY005 (1").

Комплект подключения для R790, R790B, R792, R792B с резьбовым наружным соединением R795MY004 (3/4") и R795MY005 (1").



## P790-2

| PRODUCT CODE    | SIZE   | □ | ⊞  |
|-----------------|--------|---|----|
| <b>P790Y002</b> | 1/4" F | 1 | 50 |

Adaptor for pressure outlet.

Adaptateur pour la prise de pression.

Адаптер для штуцера изменения давления.



### NOTES

The adaptor for the connection to the test instrument (P790Y002) shall be used when the pressure outlet is not compatible with the running test instrument.

L'adaptateur pour le raccordement à l'instrument d'essai (P790Y002) s'utilise lorsque la sortie de pression est incompatible avec l'instrument effectuant l'essai.

Адаптер для контрольного инструмента (P790Y002) используется в случае, если инструмент не совместим с контрольным отводом.

## Installation examples of the ball valves after the meter - Exemples d'installation des vanne à bille après le compteur Примеры установки шарового крана после счетчика

### Installation of R790-R792 in closed cabinet with exclusive use key · Installation du R790-R792 en coffret fermée avec clé d'utilisation exclusive

#### Установка R790-R792 в шкаф, закрываемый ключом:

The application example reported below shows the installation of the valves R790 – R792 (product R792 in this case) in which the valve and the pressure outlet are operated exclusively by the interested user, as they are closed into the specific cabinet with key of exclusive use. The fitting R795F –M shall be mounted to the valve for the connection with iron pipe, or product R795V shall be used for the connection with copper pipe.

L'exemple d'application indiqué ci-dessous montre l'installation des vannes R790 – R792 (produit R792 dans ce cas) dans lequel la vanne et la sortie de pression sont actionnées exclusivement par l'utilisateur intéressé, car elles sont fermées dans le coffret spécifique avec la clé d'utilisation exclusive. Le raccordement R795F –M doit être monté sur la vanne pour le raccordement avec le tube en fer, ou le produit R795V doit être utilisé pour le raccordement avec un tube en cuivre.

Пример, приводимый ниже, показывает установку кранов R790 – R792 (R792 в данном случае), в котором кран и отвод контроля давления обслуживаются только уполномоченным персоналом, будучи установленными в шкафу с замком. Фитинг R795F –M устанавливается на кран для соединения со стальной трубой, R795V используется для соединения с медной трубой.

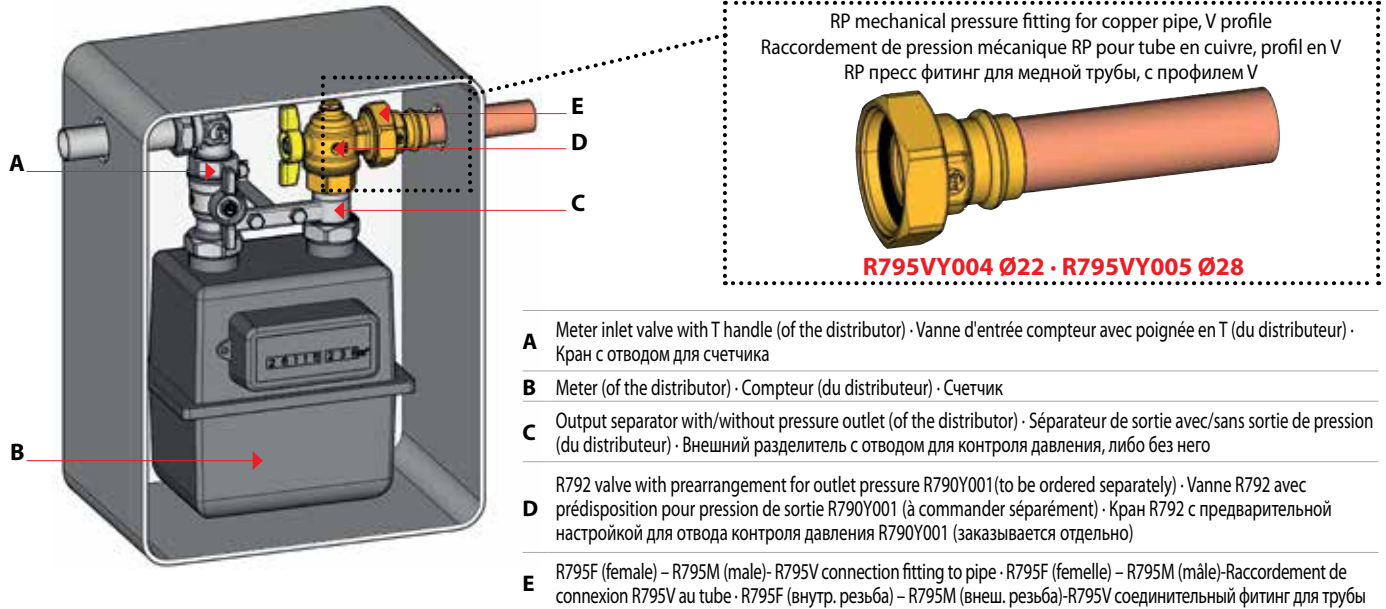

### R790B – R792B installation in series · Installation R790B – R792B en série · R790B – R792B установка:

The application example reported below shows the installation of the valves R790B – R792B in series (R790B in this case), in which to satisfy the safety requirements demanded by the norm, the valves are equipped with safety lock preventing from accidental openings, with key and pressure outlet with quick connection and rubber protection. The fitting R795F –M shall be mounted to the valve for the connection with iron pipe, or product R795V shall be used for the connection with copper pipe.

L'exemple d'application indiqué ci-dessous montre l'installation des vannes R790B – R792B en série (R790B dans ce cas), dans laquelle, pour satisfaire les conditions de sécurité requises par la norme, les vannes sont équipées d'un verrouillage de sécurité évitant les ouvertures accidentelles, avec une clé et une sortie de pression à raccordement rapide et protection en caoutchouc. Le raccordement R795F –M doit être monté sur la vanne pour le raccordement avec le tube en fer, ou le produit R795V doit être utilisé pour le raccordement avec un tube en cuivre.

Пример, приводимый ниже, показывает установку кранов R790B – R792B (R790B в данном случае), в котором, в целях безопасности, кран снабжен блокиратором для предотвращения случайного открытия, с ключом и отводом для контроля давления, с резиновым предохранительным колпачком. Фитинг R795F –M устанавливается на кран для соединения со стальной трубой, R795V используется для соединения с медной трубой.

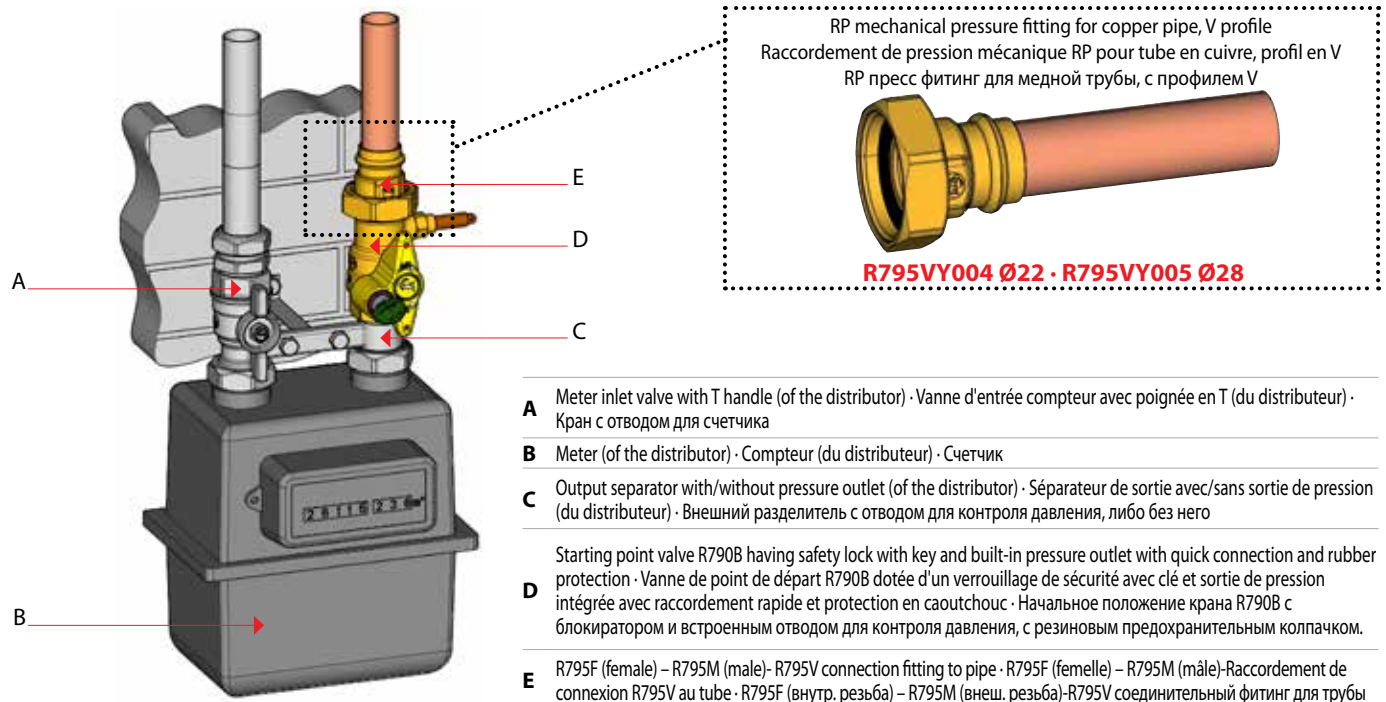

## R780L

| PRODUCT CODE     | SIZE | □ | ⊞  |
|------------------|------|---|----|
| <b>R780LX003</b> | 1/2" | 5 | 50 |
| <b>R780LX004</b> | 3/4" | 5 | 50 |
| <b>R780LX005</b> | 1"   | 3 | 30 |

MxF full port angle ball valve, yellow lever handle, chrome plated.

Vanne équerre MxF à passage intégral, chromée, poignée jaune.

Кран шаровый угловой полнопроходный с желтой рычажной рукояткой, с внутренней и наружной резьбой, хромированный.



## R780

| PRODUCT CODE    | SIZE | □ | ⊞  |
|-----------------|------|---|----|
| <b>R780X003</b> | 1/2" | 5 | 50 |
| <b>R780X004</b> | 3/4" | 5 | 50 |
| <b>R780X005</b> | 1"   | 3 | 30 |

MxF full port angle ball valve, yellow T-handle, chrome plated.

Vanne équerre MxF à passage intégral, chromée, papillon jaune.

Кран шаровый угловой полнопроходный с желтой рукояткой, с внутренней и наружной резьбой, хромированный.



## R781L

| PRODUCT CODE     | SIZE | □ | ⊞  |
|------------------|------|---|----|
| <b>R781LX003</b> | 1/2" | 5 | 50 |
| <b>R781LX004</b> | 3/4" | 5 | 50 |
| <b>R781LX005</b> | 1"   | 3 | 30 |

FxM full port angle ball valve, yellow lever handle, chrome plated.

Vanne équerre FxM à passage intégral, chromé, poignée jaune.

Кран шаровый угловой полнопроходный с желтой рычажной рукояткой, с внутренней и наружной резьбой, хромированный.



## R781

| PRODUCT CODE    | SIZE | □ | ⊞  |
|-----------------|------|---|----|
| <b>R781X003</b> | 1/2" | 5 | 50 |
| <b>R781X004</b> | 3/4" | 5 | 50 |
| <b>R781X005</b> | 1"   | 3 | 30 |

FxM full port angle ball valve, yellow T handle, chrome plated.

Vanne équerre FxM à passage intégral, chromé, papillon jaune.

Кран шаровый угловой полнопроходный с желтой рукояткой, с внутренней и наружной резьбой, хромированный.



## R782L

| PRODUCT CODE     | SIZE | □ | ⊞  |
|------------------|------|---|----|
| <b>R782LX003</b> | 1/2" | 5 | 50 |
| <b>R782LX004</b> | 3/4" | 5 | 50 |
| <b>R782LX005</b> | 1"   | 3 | 30 |

MxM full port angle ball valve, yellow lever handle, chrome plated.

Vanne équerre MxM à passage intégral, chromé, poignée jaune.

Кран шаровый угловой полнопроходный с желтой рычажной рукояткой, с наружной резьбой, хромированный.



## R782

| PRODUCT CODE    | SIZE | □ | ⊞  |
|-----------------|------|---|----|
| <b>R782X003</b> | 1/2" | 5 | 50 |
| <b>R782X004</b> | 3/4" | 5 | 50 |
| <b>R782X005</b> | 1"   | 3 | 30 |

MxM full port angle ball valve, yellow T handle, chrome plated.

Vanne équerre MxF à passage intégral, chromé, papillon jaune.

Кран шаровый угловой полнопроходный с желтой рукояткой, с наружной резьбой, хромированный.



## R783L

| PRODUCT CODE     | SIZE | □ | ⊞  |
|------------------|------|---|----|
| <b>R783LX003</b> | 1/2" | 5 | 50 |
| <b>R783LX004</b> | 3/4" | 5 | 50 |
| <b>R783LX005</b> | 1"   | 3 | 30 |

FxF full port angle ball valve, yellow lever handle, chrome plated.

Vanne équerre FxF à passage intégral, chromé, poignée jaune.

Кран шаровый угловой полнопроходный с желтой рычажной рукояткой, с внутренней резьбой, хромированный.



## R783

| PRODUCT CODE    | SIZE | □ | ⊞  |
|-----------------|------|---|----|
| <b>R783X003</b> | 1/2" | 5 | 50 |
| <b>R783X004</b> | 3/4" | 5 | 50 |
| <b>R783X005</b> | 1"   | 3 | 30 |

FxF full port angle ball valve, yellow T handle, chrome plated.

Vanne équerre FxF à passage intégral, chromé, papillon jaune.

Кран шаровый угловой полнопроходный с желтой рукояткой, с внутренней резьбой, хромированный.





## R250DG

| PRODUCT CODE | SIZE   | □ | ⊞ |
|--------------|--------|---|---|
| R250GX002    | 3/8"   | - | - |
| R250GX003    | 1/2"   | - | - |
| R250GX004    | 3/4"   | - | - |
| R250GX005    | 1"     | - | - |
| R250GX006    | 1 1/4" | - | - |
| R250GX007    | 1 1/2" | - | - |
| R250GX008    | 2"     | - | - |



Standard port ball valve, yellow lever handle, chrome plated, ISO 7 thread. DVGW compliant for Gas use from 4 to 1 bar HTB Quality in accordance with EN331 MOP 5. DVGW Registered Nr.: DIN-DVGW NG-4312BU0479 for gas.

Vanne à boisseau à port standard, poignée jaune, chromée, filetage ISO 7. Homologation DVGW pour l'utilisation des gaz de 4 à 1 bar Qualité HTB Quality conformément à la norme EN331 MOP 5. N° DVGW enregistré: DIN-DVGW NG-4312BU0479 pour gaz.

Шаровый кран со стандартным проходом, рукоятка рычажная желтая, хромированный, резьба по ISO 7. В соответствии с DVGW использование для газа от 4 до 1 бар HTB Quality в соответствии с EN331 MOP 5. DVGW номер регистрации: DIN-DVGW NG-4312BU0479 для газа.

## R253D

| PRODUCT CODE | SIZE   | □  | ⊞   |
|--------------|--------|----|-----|
| R253X022     | 3/8"   | 10 | 100 |
| R253X023     | 1/2"   | 10 | 100 |
| R253X024     | 3/4"   | 5  | 50  |
| R253X025     | 1"     | 5  | 50  |
| R253X026     | 1 1/4" | 4  | 20  |



Male x male standard port ball valve, yellow T handle, chrome plated.

Vanne à boisseau sphérique mâle mâle, passage standard, poignée papillon jaune, chromée.

Кран шаровый, резьба наружная/наружная, стандартный проход, хромированный, ручка - бабочка желтая.

## R254D

| PRODUCT CODE | SIZE   | □  | ⊞   |
|--------------|--------|----|-----|
| R254X021     | 1/4"   | 20 | 200 |
| R254X022     | 3/8"   | 10 | 100 |
| R254X023     | 1/2"   | 10 | 100 |
| R254X024     | 3/4"   | 5  | 50  |
| R254X025     | 1"     | 5  | 50  |
| R254X026     | 1 1/4" | 4  | 20  |



Male x female standard port ball valve, yellow T handle, chrome plated.

Vanne à boisseau sphérique mâle femelle, passage standard, poignée papillon jaune, chromée.

Кран шаровый, резьба внутренняя/наружная, стандартный проход, хромированный, ручка - бабочка желтая.

## R251D

| PRODUCT CODE | SIZE   | □  | ⊞   |
|--------------|--------|----|-----|
| R251X021     | 1/4"   | 20 | 200 |
| R251X022     | 3/8"   | 10 | 100 |
| R251X023     | 1/2"   | 10 | 100 |
| R251X024     | 3/4"   | 5  | 50  |
| R251X025     | 1"     | 5  | 25  |
| R251X026     | 1 1/4" | 5  | 25  |



Standard port ball valve, yellow T-handle, chrome plated.

Vanne à boisseau sphérique, passage standard, poignée papillon jaune, chromée.

Кран шаровый, резьба внутренняя/внутренняя, стандартный проход, хромированный, ручка - бабочка желтая.

## R250D

| PRODUCT CODE | SIZE   | □  | ⊞   |
|--------------|--------|----|-----|
| R250X021     | 1/4"   | 20 | 200 |
| R250X022     | 3/8"   | 10 | 100 |
| R250X023     | 1/2"   | 10 | 100 |
| R250X024     | 3/4"   | 5  | 50  |
| R250X025     | 1"     | 5  | 25  |
| R250X026     | 1 1/4" | 4  | 20  |
| R250X027     | 1 1/2" | 2  | 10  |
| R250X028     | 2"     | 2  | 10  |
| R250X029     | 2 1/2" | 2  | 6   |
| R250X030     | 3"     | 2  | 4   |
| R250X031     | 4"     | 1  | 2   |



Standard port ball valve, yellow lever handle, chrome plated.

Vanne à boisseau sphérique, passage standard, poignée jaune, chromée.

Кран шаровый, резьба внутренняя/внутренняя, стандартный проход, хромированный, ручка - рычаг желтый.

## R253DL

| PRODUCT CODE | SIZE   | □  | ⊞   |
|--------------|--------|----|-----|
| R253LX022    | 3/8"   | 10 | 100 |
| R253LX023    | 1/2"   | 10 | 100 |
| R253LX024    | 3/4"   | 5  | 50  |
| R253LX025    | 1"     | 2  | 20  |
| R253LX026    | 1 1/4" | 2  | 20  |



Male x male standard port ball valve, yellow lever handle, chrome plated.

Vanne à boisseau sphérique mâle mâle, passage standard, poignée rjaune, chromée.

Кран шаровый, резьба наружная/наружная, стандартный проход, хромированный, ручка - рычаг желтый.

## R254DL

| PRODUCT CODE | SIZE   | □  | ⊞   |
|--------------|--------|----|-----|
| R254LX021    | 1/4"   | 20 | 200 |
| R254LX022    | 3/8"   | 10 | 100 |
| R254LX023    | 1/2"   | 10 | 100 |
| R254LX024    | 3/4"   | 5  | 50  |
| R254LX025    | 1"     | 2  | 20  |
| R254LX026    | 1 1/4" | 2  | 20  |
| R254LX027    | 1 1/2" | 2  | 10  |
| R254LX028    | 2"     | 2  | 10  |



Male x female standard port ball valve, yellow lever handle, chrome plated.

Vanne à boisseau sphérique mâle femelle, passage standard, poignée jaune, chromée.

Кран шаровый, резьба внутренняя/наружная, стандартный проход, хромированный, ручка - рычаг желтый.

## R602

| PRODUCT CODE | SIZE | □  | ⊞   |
|--------------|------|----|-----|
| R602Y013     | 1/2" | 10 | 100 |
| R602Y014     | 3/4" | 5  | 50  |



Gas ball valve female x female connections, lever handle, brass finish.

Robinet laiton à boisseau sphérique raccord femelle x femelle, poignée droite.

Кран шаровый с внутренней резьбой, нехромированный, рычажной рукояткой.

## > DRAIN TAPS

### ROBINETS DE VIDANGE

### СЛИВНЫЕ КРАНЫ

#### R603

| PRODUCT CODE | SIZE | □ | ⊞  |
|--------------|------|---|----|
| R603X103     | 1/2" | 5 | 50 |
| R603X104     | 3/4" | 5 | 50 |

Ball valve with tail piece, female x male connections, T- handle, nickel plated.

Robinet à boisseau sphérique, démontable, nickelé, raccord mâle x femelle, poignée papillon.

Шаровой кран с наружной и внутренней резьбой, ручкой-бабочкой, с отводом, никелированный.



#### R604

| PRODUCT CODE | SIZE | □ | ⊞  |
|--------------|------|---|----|
| R604Y104     | 3/4" | 5 | 50 |

Brass ball valve, square top. Female iron x Male union connection.

Robinet à sphère non chromé, manoeuvre par carré. Raccordement mâle femelle.

Шаровый кран нехромированный, под четырехгранный ключ, соединения с наружной и внутренней резьбой.



#### R608

| PRODUCT CODE | SIZE | □ | ⊞   |
|--------------|------|---|-----|
| R608Y012     | 3/8" | 1 | 100 |
| R608Y013     | 1/2" | 1 | 50  |
| R608Y014     | 3/4" | 1 | 50  |
| R608Y022     | 3/8" | 1 | 100 |
| R608Y023     | 1/2" | 1 | 100 |
| R608Y024     | 3/4" | 1 | 50  |
| R608Y032     | 3/8" | 1 | 100 |
| R608Y033     | 1/2" | 1 | 100 |
| R608Y034     | 3/4" | 1 | 100 |

Drain cock male connection, brass finish.

Robinet laiton à boisseau sphérique avec porte-caoutchouc.

Выпускной кран с наружной резьбой, под отвертку, нехромированный.

##### NOTES

- R608Y012, R608Y013, R608Y014: completed · complet · полный комплект.
- R608Y022, R608Y023, R608Y024: without cap and chain · sans bouchon ni chaîne · без заглушки и цепочки.
- R608Y032, R608Y033, R608Y034: without hose sans tuyau · без штуцера для шланга.



#### R608D

| PRODUCT CODE | SIZE | □ | ⊞   |
|--------------|------|---|-----|
| R608DY113    | 1/2" | 1 | 100 |
| R608DY123    | 1/2" | 1 | 100 |
| R608DY133    | 1/2" | 1 | 100 |

Drain cock male connection, brass finish, with handle, self-sealing.

Robinet à boisseau sphérique autoétanche laiton avec poignée papillon, porte caoutchouc et bouchon.

Выпускной кран с наружной резьбой, нехромированный, с рукояткой и герметичной прокладкой.

##### NOTES

- R608DY113: completed · complet · полный комплект.
- R608DY123: without cap and chain · sans bouchon ni chaîne · без заглушки и цепочки.
- R608DY133: without hose · sans tuyau · без штуцера для шланга.



#### R609

| PRODUCT CODE | SIZE | □  | ⊞   |
|--------------|------|----|-----|
| R609Y013     | 1/2" | 10 | 100 |
| R609Y014     | 3/4" | 5  | 50  |

Drain cock male-female connections, brass finish.

Robinet laiton à boisseau sphérique sans porte-caoutchouc et bouchon.

Выпускной кран с наружной и внутренней резьбой, под отвертку, нехромированный.

##### NOTES

R609Y022, R609Y023, R609Y024: without cap and chain.



#### R610

| PRODUCT CODE | SIZE | □  | ⊞   |
|--------------|------|----|-----|
| R610Y003     | 1/2" | 10 | 100 |

Drain cock male x male connections, slot adjustment, brass finish.

Robinet laiton à boisseau sphérique raccord mâle x mâle.

Выпускной кран с наружной резьбой, под отвертку, нехромированный.



#### R611

| PRODUCT CODE | SIZE | □  | ⊞   |
|--------------|------|----|-----|
| R611Y012     | 3/8" | 10 | 100 |
| R611Y013     | 1/2" | 10 | 100 |
| R611Y014     | 3/4" | 5  | 50  |
| R611Y022     | 3/8" | 10 | 100 |
| R611Y023     | 1/2" | 10 | 100 |
| R611Y024     | 3/4" | 10 | 100 |

Drain cock female x female connections, slot adjustment, brass finish.

Robinet laiton à boisseau sphérique femelle x femelle.

Выпускной кран с внутренней резьбой, под отвертку, нехромированный.

##### NOTES

- R611Y012, R611Y013, R611Y014: without cap and chain · sans bouchon ni chaîne · без заглушки и цепочки.
- R611Y022, R611Y023, R611Y024: completed complet · полный комплект.



#### R612

| PRODUCT CODE | SIZE      | □  | ⊞   |
|--------------|-----------|----|-----|
| R612Y003     | 1/2" x 16 | 10 | 100 |

Drain cock male-adaptor connections, slot adjustment, brass finish, to be completed with R178 or R179.

Robinet laiton à boisseau sphérique, ajouter R178 ou R179.

Выпускной кран с под отвертку, с выводами для переходников R178 или R179 с внешней резьбой, нехромированный.



#### R248M1

| PRODUCT CODE | SIZE            | □ | ⊞  |
|--------------|-----------------|---|----|
| R248Y003     | 1/2" M x 3/4" M | 5 | 50 |

Drain tap male x male connections, brass finish.

Robinet de vidange, laiton avec bouchon et chaîne poignée papillon.

Выпускной кран с наружной резьбой, с ручкой-бабочкой.



## R248F1

| PRODUCT CODE    | SIZE            | □ | ⊞  |
|-----------------|-----------------|---|----|
| <b>R248Y004</b> | 1/2" F x 3/4" M | 5 | 50 |

Drain tap female x male connections, brass finish.

Robinet de vidange, laiton avec bouchon et chaîne poignée papillon.

Выпускной кран с внутренней и наружной резьбой, нехромированный, с ручкой-бабочкой.



## R621

| PRODUCT CODE    | SIZE | □ | ⊞  |
|-----------------|------|---|----|
| <b>R621X003</b> | 1/2" | 5 | 50 |
| <b>R621X004</b> | 3/4" | 5 | 50 |
| <b>R621X005</b> | 1/2" | 5 | 50 |

Bib tap with hose connection, lever handle, chrome plated.

Robinet de service avec porte caoutchouc.

Кран для садового шланга с выводом для резинового шланга, с рычажной ручкой, хромированный.



## R619

| PRODUCT CODE     | SIZE | □ | ⊞  |
|------------------|------|---|----|
| <b>R619IX103</b> | 1/2" | 5 | 50 |

Quarter turn hose union tap.

Robinet de service avec porte caoutchouc.

Кран для садового шланга с флажковой ручкой.



## R622

| PRODUCT CODE    | SIZE | □ | ⊞   |
|-----------------|------|---|-----|
| <b>R622X004</b> | 3/4" | 1 | 200 |

Manual draining hose connection vacuum breaker, chrome plated.

Disconnecteur d'extrémité.

Предохранитель обратного течения для садового крана, хромированный.



## R620

| PRODUCT CODE    | SIZE | □ | ⊞  |
|-----------------|------|---|----|
| <b>R620X003</b> | 1/2" | 5 | 50 |
| <b>R620X004</b> | 3/4" | 5 | 50 |

Bib tap with hose connection, T handle, chrome plated.

Robinet de service avec porte caoutchouc.

Кран для садового шланга с выводом для резинового шланга, с ручкой-бабочкой, хромированный.



## > ACCESSORIES AND SPARE PARTS ACCESSOIRES ET PIÈCES DE RECHANGE АКСЕССУАРЫ И ЗАПАСНЫЕ ЧАСТИ

### R288

| PRODUCT CODE    | SIZE   | □  | ⊞   |
|-----------------|--------|----|-----|
| <b>R288Y005</b> | 1"     | 25 | 250 |
| <b>R288Y006</b> | 1 1/4" | 25 | 250 |

Plastic stop for ball valves (R285, R285L, R287M series) and mixing valves (R296, R298 series).

Clapet anti-retour en plastique pour vannes à boisseau sphérique et vannes à passage direct. A utiliser avec R285, R285L, R287M, R296, R298 vannes.

Пластиковый обратный клапан для кранов шаровых и задвижек. Используется для R285, R285L, R287M, R296, R298.

#### NOTES

1": for R285Y001, R285Y002, R285LY001, R285LY002, R287MY005 · pour R285Y001, R285Y002, R285LY001, R285LY002 · Для кранов серий R285Y001, R285Y002, R285LY001, R285LY002, R287MY005.

1 1/4": for R285LY003, R285Y003, R296Y001, R298Y001 · pour R285LY003, R285Y003, R296Y001, R298Y001 · Для кранов серий R285LY003, R285Y003, R296Y001, R298Y001.



### R746

| PRODUCT CODE    | SIZE               | □  | ⊞   |
|-----------------|--------------------|----|-----|
| <b>R746X002</b> | 3/4" - 1" - 1 1/4" | 10 | 100 |

Gear for ball valves models R250, R910, R950, R850.

Réducteur de manoeuvre pour vannes à sphère modèle R250, R910, R950, R850.

Устройство для уменьшения скорости открытия/закрытия шаровых кранов моделей R250, R910, R950, R850.



## R749T

chrome plated - chromé - хромированный

| PRODUCT CODE | SIZE               | □  | ⊞   |
|--------------|--------------------|----|-----|
| R749TX101    | 3/8" - 1/2"        | 25 | 250 |
| R749TX102    | 3/4" - 1" - 1 1/4" | 10 | 100 |
| R749TX103    | 1 1/2" - 2"        | 10 | 100 |
| R749TX004    | 2 1/2" - 3"        | 5  | 50  |
| R749TX005    | 4"                 | 5  | 50  |
| R749TY101    | 3/8" - 1/2"        | 25 | 250 |
| R749TY102    | 3/4" - 1" - 1 1/4" | 10 | 100 |
| R749TY103    | 1 1/2" - 2"        | 5  | 50  |
| R749TY004    | 2 1/2" - 3"        | 5  | 50  |
| R749TY005    | 4"                 | 5  | 50  |

Cylinder extension for ball valves.

Rehausse tubulaire chromée pour la poignée des vannes à sphère.

Цилиндрический удлинитель для рукояток шаровых кранов, хромированный.

### NOTES

- R759TX004: for R850 (4" excluded) and R250 (4" excluded) valves. pour vannes R850 (à l'exclusion des 4") et R250 (à l'exclusion des 4"). для кранов R850 (исключая 4") и R250 (исключая 4").
- R749TX005: for R910, R850 (4" only) and R250 (4" only) valves. pour vannes R910, R850 (4" uniquement) et R250 (4" uniquement). для кранов R910, R850 (только 4") и R250 (только 4").

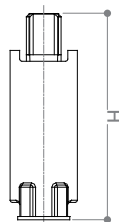

### TUBULAR WEDGE FOR BALL VALVES HANDLES - BUTÉE TUBULAIRE POUR POIGNÉES DE VANNE À BOISSEAU ТРУБАЧАТЫЙ УДЛИНИТЕЛЬ ШТОКА ШАРОВЫХ КРАНОВ

| CHROME PLATED<br>CHROMÉ<br>НЕХРОМИРОВАННЫЙ | BRASS FINISHED<br>LAITON<br>ХРОМИРОВАННЫЙ | USE - UTILISATION - ИСПОЛЬЗОВАНИЕ   | H    |
|--|---|---|------|
| R749TX101                                  | R749TY101                                 | 3/8"-1/2" ball valves with guarantee seal and hologram<br>Vannes à bille 3/8"-1/2" avec sceau de garantie et hologramme<br>для кранов размером 3/8"-1/2" с гарантийной пломбой и голограммой                | 50   |
| R749TX102                                  | R749TY102                                 | 3/4"-1"-1 1/4" ball valves with guarantee seal and hologram<br>Vannes à bille 3/4"-1"-1 1/4" avec sceau de garantie et hologramme<br>для кранов размером 3/4"-1"-1 1/4" с гарантийной пломбой и голограммой | 61,5 |
| R749TX103                                  | R749TY103                                 | 1 1/2"-2" ball valves with guarantee seal and hologram<br>Vannes à bille 1 1/2"-2" avec sceau de garantie et hologramme<br>для кранов размером 1 1/2"-2" с гарантийной пломбой и голограммой                | 81   |
| R749TX004                                  | R749TY004                                 | 2 1/2"-3" ball valves serie R250 - Vannes à bille 2 1/2"-3" serie R250<br>для кранов размером 2 1/2"-3" серии R250  | 93,5 |
| R749TX005                                  | R749TY005                                 | 4" ball valves serie R250 and 2 1/2"-3" serie DADO R910<br>Vannes à bille 4" serie R250 et 2 1/2"-3" serie ÉCROU R910<br>для кранов размером 4" серии R250 и 2 1/2"-3" серии DADO R910                      | 107  |

## R747

| PRODUCT CODE | SIZE               | □   | ⊞     |
|--------------|--------------------|-----|-------|
| R747Y001     | 3/8" - 1/2"        | 100 | 1.000 |
| R747Y002     | 3/4" - 1" - 1 1/4" | 100 | 1.000 |
| R747Y003     | 1 1/2" - 2"        | 100 | 1.000 |

Locking device for ball valves (Placing this locking device under the handle allows the valve to be locked in either open or closed position).

Platine de blocage pour la poignée des vannes à sphère (placer ce dispositif sous la poignée permet à la vanne de rester bloquée en position ouverte ou fermée).

Блокирующее устройство для рукояток шаровых кранов.



## R749F

| PRODUCT CODE | SIZE               | □ | ⊞ |
|--------------|--------------------|---|---|
| R749FY001    | 3/8" - 1/2"        | 1 | - |
| R749FY002    | 3/4" - 1" - 1 1/4" | 1 | - |
| R749FY003    | 1 1/2" - 2"        | 1 | - |

Plastic extended handle for ball valves.

Poignée de prolongation pour vanne à sphère.

Пластмассовая удлиненная рукоятка для шаровых клапанов.

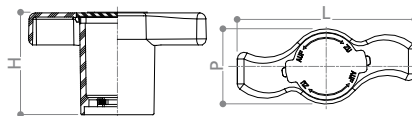

### INSTALLATION SEQUENCE - SÉQUENCE D'INSTALLATION - ПОРЯДОК УСТАНОВКИ



Unscrew the nut with the special wrench.

Dévisser l'écrou avec la clé spéciale.

Открутите гайку штока.

Remove the lever.

Retirer la vis.

Снимите ручку.



Position the handle raised R749F.

Placer la poignée référencée R749F.

Установите удлинитель R749F.

Put back the lever and with the special wrench tightly screw the nut.

Remettre la vis et, avec la clé spéciale, revisser l'écrou.

Установите ручку и плотно закрутите гайку.



## R540F

| PRODUCT CODE     | SIZE            | ☐ | ☒   |
|------------------|-----------------|---|-----|
| <b>R540FY002</b> | 0÷120 °C - red  | 6 | 288 |
| <b>R540FY022</b> | 0÷120 °C - blue | 6 | 288 |

Thermometer 0 °C-120 °C, for R749F plastic handles.

Thermomètre 0 °C-120 °C, pour les poignées synthétiques R749F.

Термометр 0 °C-120 °C для рукояток шаровых кранов R749F.



## P31LV

| PRODUCT CODE     | SIZE               | ☐ | ☒   |
|------------------|--------------------|---|-----|
| <b>P31LVY102</b> | 3/8" - 1/2"        | 1 | 100 |
| <b>P31LVY103</b> | 3/4" - 1" - 1 1/4" | 1 | 25  |
| <b>P31LVY104</b> | 1 1/2" - 2"        | 1 | 25  |

Lever handle for ball valves.

Poignée à levier.

Рычажная рукоятка зеленая.



### INFO

Please indicate in your order the model and the relative size of the valve.

Merci d'indiquer dans votre commande le modèle et la taille de la vanne.

Пожалуйста, укажите в заказе модель и размер шарового крана.

## R37

### brass finish - laiton - хромированный

| PRODUCT CODE   | SIZE      | ☐ | ☒ |
|----------------|-----------|---|---|
| <b>R37Y003</b> | 1/2"x3/4" | 0 | - |
| <b>R37Y004</b> | 3/4"x1"   | 0 | - |

### chrome plated - chromé - нехромированный

| PRODUCT CODE   | SIZE      | ☐ | ☒ |
|----------------|-----------|---|---|
| <b>R37X003</b> | 1/2"x3/4" | 0 | - |
| <b>R37X004</b> | 3/4"x1"   | 0 | - |

Meter connection fitting, brass finish.

Raccord mâle/femelle.

Отвод с накидной гайкой для счетчиков, нехромированный.



## P31FR

| PRODUCT CODE     | SIZE               | ☐ | ☒ |
|------------------|--------------------|---|---|
| <b>P31FRY001</b> | 1/4"               | 1 | - |
| <b>P31FRY002</b> | 3/8" - 1/2"        | 1 | - |
| <b>P31FRY003</b> | 3/4" - 1" - 1 1/4" | 1 | - |

T handle for ball valves.

Poignée papillon.

Ручка-бабочка красная.



### INFO

Please indicate in your order the model and the relative size of the valve.

Merci d'indiquer dans votre commande le modèle et la taille de la vanne.

Пожалуйста, укажите в заказе модель и размер шарового крана.

## P31LR

| PRODUCT CODE     | SIZE               | ☐ | ☒   |
|------------------|--------------------|---|-----|
| <b>P31LRY001</b> | 1/4"               | 1 | -   |
| <b>P31LRY005</b> | 2 1/2" - 3"        | 1 | -   |
| <b>P31LRY006</b> | 4"                 | 1 | -   |
| <b>P31LRY102</b> | 3/8" - 1/2"        | 1 | 100 |
| <b>P31LRY103</b> | 3/4" - 1" - 1 1/4" | 1 | 25  |
| <b>P31LRY104</b> | 1 1/2" - 2"        | 1 | 25  |

Lever handle for ball valves.

Poignée à levier.

Рычажная рукоятка красная.

### INFO

Please indicate in your order the model and the relative size of the valve.

Merci d'indiquer dans votre commande le modèle et la taille de la vanne.

Пожалуйста, укажите в заказе модель и размер клапана.



## P31FG

| PRODUCT CODE     | SIZE               | ☐ | ☒ |
|------------------|--------------------|---|---|
| <b>P31FGY001</b> | 1/4"               | 1 | - |
| <b>P31FGY002</b> | 3/8" - 1/2"        | 1 | - |
| <b>P31FGY003</b> | 3/4" - 1" - 1 1/4" | 1 | - |

T handle for ball valves.

Poignée papillon.

Ручка-бабочка желтая.



### INFO

Please indicate in your order the model and the relative size of the valve.

Merci d'indiquer dans votre commande le modèle et la taille de la vanne.

Пожалуйста, укажите в заказе модель и размер шарового крана.

## P31LG

| PRODUCT CODE     | SIZE               | ☐ | ☒   |
|------------------|--------------------|---|-----|
| <b>P31LGY001</b> | 1/4"               | 1 | -   |
| <b>P31LGY005</b> | 2 1/2" - 3"        | 1 | -   |
| <b>P31LGY006</b> | 4"                 | 1 | -   |
| <b>P31LGY102</b> | 3/8" - 1/2"        | 1 | 100 |
| <b>P31LGY103</b> | 3/4" - 1" - 1 1/4" | 1 | 25  |
| <b>P31LGY104</b> | 1 1/2" - 2"        | 1 | 25  |

Lever handle for ball valves.

Poignée à levier.

Рычажная рукоятка желтая.

### INFO

Please indicate in your order the model and the relative size of the valve.

Merci d'indiquer dans votre commande le modèle et la taille de la vanne.

Пожалуйста, укажите в заказе модель и размер шарового крана.



## R625

### brass finish - laiton - нехромированный

| PRODUCT CODE    | SIZE | ☐ | ☒ |
|-----------------|------|---|---|
| <b>R625X002</b> | 3/8" | 1 | - |
| <b>R625X003</b> | 1/2" | 1 | - |
| <b>R625X004</b> | 3/4" | 1 | - |
| <b>R625Y002</b> | 3/8" | 1 | - |
| <b>R625Y003</b> | 1/2" | 1 | - |
| <b>R625Y004</b> | 3/4" | 1 | - |

Hose connection for R608, R619, R620 and R621 ball valves, brass finish.

Porte caoutchouc pour R608, R619, R620 et R621.

Патрубок для резинового шланга для шаровых клапанов R608, R619, R620 и R621, нехромированный.



## P18L

| PRODUCT CODE    | SIZE                    | □  | ⊞   |
|-----------------|-------------------------|----|-----|
| <b>P18LY007</b> | 1 1/2" for R252 - R285L | 20 | 200 |
| <b>P18LY008</b> | 1 1/2" for R287         | 25 | 250 |
| <b>P18LY009</b> | 2" - R252               | 20 | 100 |

Brass nut.

Ecrou pour douille.

Гайка для прямых фитингов.



## P22F

| PRODUCT CODE    | SIZE        | □ | ⊞ |
|-----------------|-------------|---|---|
| <b>P22FY001</b> | 3/8" - 1/2" | 1 | - |
| <b>P22FY003</b> | 3/4"        | 1 | - |
| <b>P22FY011</b> | 3/8" - 1/2" | 1 | - |
| <b>P22FY013</b> | 3/4"        | 1 | - |

Red T handle for R601 and R603 gas ball valves gas ball valves.

Poignée pour robinet à sphère R601 et R603.

Красная дроссельная рукоятка для шаровых кранов R601 и R603.



### INFO

Please indicate in your order the model and the relative size of the valve.

Merci d'indiquer dans votre commande le modèle et la taille de la vanne.

Пожалуйста, укажите в заказе модель и размер крана.

## P22L

| PRODUCT CODE    | SIZE        | □ | ⊞ |
|-----------------|-------------|---|---|
| <b>P22LY001</b> | 3/8" - 1/2" | 1 | - |
| <b>P22LY003</b> | 3/4"        | 1 | - |
| <b>P22LY011</b> | 3/8" - 1/2" | 1 | - |
| <b>P22LY013</b> | 3/4"        | 1 | - |

Red lever for R602 and R610F gas ball valves.

Poignée pour robinet à sphère R602, R610F.

Красная флажковая рукоятка для шаровых кранов R602 и R610F.



### INFO

Please indicate in your order the model and the relative size of the valve.

Merci d'indiquer dans votre commande le modèle et la taille de la vanne.

Пожалуйста, укажите в заказе модель и размер крана.

## P22C

| PRODUCT CODE    | SIZE        | □ | ⊞ |
|-----------------|-------------|---|---|
| <b>P22CY001</b> | 3/8" - 1/2" | 1 | - |
| <b>P22CY002</b> | 3/4" - 1"   | 1 | - |
| <b>P22CY003</b> | 1 1/4"      | 1 | - |
| <b>P22CY004</b> | 1 1/2"      | 1 | - |
| <b>P22CY005</b> | 2"          | 1 | - |
| <b>P22CY008</b> | 2 1/2" - 3" | 1 | - |

Red handwheel for R281, R289, R289S ball valves and R55, R220, R230, R54FL gate valves.

Poignée pour vanne R281, R289, R289S, R55, R220, R230, R54FL.

Красный маховик для шаровых кранов R281, R289, R289S и задвижек R55, R220, R230, R54FL.



### INFO

Please indicate in your order the model and the relative size of the valve.

Merci d'indiquer dans votre commande le modèle et la taille de la vanne.

Пожалуйста, укажите в заказе модель и размер крана или задвижки.

## P23F

| PRODUCT CODE    | SIZE | □ | ⊞ |
|-----------------|------|---|---|
| <b>P23FY002</b> | 3/8" | 1 | - |
| <b>P23FY003</b> | 1/2" | 1 | - |
| <b>P23FY004</b> | 3/4" | 1 | - |

Brass finish female plug and chain for R608 ball valves.

Bouchon et chaînette pour R608.

Нихромированная заглушка с внутренней резьбой и цепочка для шаровых кранов R608.



## P23M

| PRODUCT CODE    | SIZE | □ | ⊞ |
|-----------------|------|---|---|
| <b>P23MY002</b> | 3/8" | 1 | - |
| <b>P23MY003</b> | 1/2" | 1 | - |
| <b>P23MY004</b> | 3/4" | 1 | - |

Brass finish male plug and chain for R609 ball valves.

Bouchon et chaînette pour R609.

Нихромированная заглушка с наружной резьбой и цепочка для шаровых кранов R609.



## P57G

| PRODUCT CODE    | SIZE            | □   | ⊞     |
|-----------------|-----------------|-----|-------|
| <b>P57GY007</b> | 1 1/2"          | 50  | 500   |
| <b>P57GY008</b> | 2" x R252       | 200 | 1.000 |
| <b>P57GY014</b> | 3/4" x R37 1/2" | 50  | 500   |
| <b>P57GY015</b> | 1" x R37 3/4"   | 50  | 500   |

Sealring for P18L.

Joint pour P18L.

Кольцевая прокладка для P18S.



## > TECHNICAL AND DIMENSIONAL DATA

### Full port ball valve

NB: check the operating conditions by referring to the specific Technical Datasheet

#### R950

| SIZE   | DN | A   | I  | B   | J  | C   | H  | Kv   |
|--------|----|-----|----|-----|----|-----|----|------|
| 1/4"   | 8  | 43  | 21 | 36  | 10 | 43  | 17 | 6,9  |
| 3/8"   | 10 | 49  | 25 | 47  | 13 | 77  | 21 | 7,0  |
| 1/2"   | 15 | 60  | 30 | 53  | 16 | 77  | 26 | 13,3 |
| 3/4"   | 20 | 68  | 34 | 69  | 21 | 95  | 32 | 25,8 |
| 1"     | 25 | 81  | 41 | 77  | 25 | 95  | 41 | 50,9 |
| 1 1/4" | 32 | 95  | 48 | 87  | 30 | 95  | 50 | 103  |
| 1 1/2" | 40 | 104 | 52 | 107 | 36 | 137 | 55 | 147  |
| 2"     | 50 | 126 | 63 | 122 | 44 | 137 | 70 | 222  |

Max. working conditions with dry saturated steam:  
 Max. working pressure at 20 °C with water and safe gases:  
 Max. operating pressure (MOP) with gas:  
 Max. working pressure at 20 °C with liquid hydrocarbons:

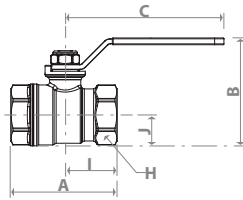

185 °C with 1,05 MPa (10,5 bar)  
 4,2 MPa (42 bar), from 1/4" to 3/4"  
 3,5 MPa (35 bar), from 1" to 2"  
 0,5 MPa (5 bar)  
 1,2 MPa (12 bar)

#### R951

| SIZE   | DN | A  | I  | B  | J  | C  | H  | Kv   |
|--------|----|----|----|----|----|----|----|------|
| 1/4"   | 8  | 43 | 21 | 36 | 10 | 42 | 17 | 6,9  |
| 3/8"   | 10 | 49 | 25 | 47 | 13 | 63 | 21 | 7,0  |
| 1/2"   | 15 | 60 | 30 | 55 | 16 | 63 | 26 | 13,3 |
| 3/4"   | 20 | 68 | 34 | 69 | 21 | 77 | 32 | 25,8 |
| 1"     | 25 | 81 | 41 | 77 | 25 | 77 | 41 | 50,9 |
| 1 1/4" | 32 | 95 | 48 | 87 | 30 | 77 | 50 | 103  |

Max. working conditions with dry saturated steam:  
 Max. working pressure at 20 °C with water and safe gases:  
 Max. operating pressure (MOP) with gas:  
 Max. working pressure at 20 °C with liquid hydrocarbons:

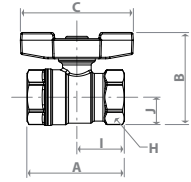

185 °C with 1,05 MPa (10,5 bar)  
 4,2 MPa (42 bar), from 1/4" to 3/4"  
 3,5 MPa (35 bar), from 1" to 1 1/4"  
 0,5 MPa (5 bar)  
 1,2 MPa (12 bar)

#### R910

| SIZE   | DN  | A   | I   | B   | J  | C   | H   | Kv   |
|--------|-----|-----|-----|-----|----|-----|-----|------|
| 3/8"   | 10  | 50  | 25  | 47  | 13 | 77  | 21  | 7,0  |
| 1/2"   | 15  | 57  | 28  | 53  | 16 | 77  | 25  | 13,3 |
| 3/4"   | 20  | 62  | 31  | 70  | 21 | 95  | 31  | 25,8 |
| 1"     | 25  | 76  | 38  | 78  | 25 | 95  | 39  | 50,9 |
| 1 1/4" | 32  | 86  | 43  | 88  | 30 | 95  | 47  | 103  |
| 1 1/2" | 40  | 97  | 48  | 109 | 37 | 137 | 54  | 147  |
| 2"     | 50  | 111 | 55  | 125 | 46 | 137 | 67  | 222  |
| 2 1/2" | 65  | 153 | 76  | 170 | 58 | 187 | 82  | 336  |
| 3"     | 80  | 173 | 87  | 189 | 68 | 187 | 96  | 377  |
| 4"     | 100 | 217 | 108 | 242 | 88 | 257 | 126 | 645  |

Max. working conditions with dry saturated steam:  
 Max. working pressure at 20 °C with water and safe gases:  
 Max. operating pressure (MOP) with gas:  
 Max. working pressure at 20 °C with liquid hydrocarbons:

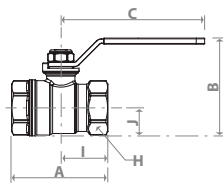

185 °C a 1,05 MPa (10,5 bar)  
 4,2 MPa (42 bar), da 1/4" a 3/4"  
 3,5 MPa (35 bar), da 1" a 2"  
 2,8 MPa (28 bar), da 2 1/2" a 4"  
 0,5 MPa (5 bar)  
 1,2 MPa (12 bar)

#### R910S

| SIZE   | DN | A   | I  | B   | J  | C   | H  | Kv   |
|--------|----|-----|----|-----|----|-----|----|------|
| 1/2"   | 15 | 62  | 34 | 52  | 16 | 77  | 25 | 13,3 |
| 3/4"   | 20 | 68  | 37 | 69  | 21 | 95  | 31 | 25,8 |
| 1"     | 25 | 82  | 44 | 77  | 25 | 95  | 39 | 50,9 |
| 1 1/4" | 32 | 100 | 57 | 87  | 30 | 95  | 47 | 103  |
| 1 1/2" | 40 | 110 | 62 | 108 | 37 | 137 | 54 | 147  |
| 2"     | 50 | 125 | 69 | 124 | 46 | 137 | 67 | 222  |

Max. working pressure at 20 °C with water:  
 Max. operating working temperature:

4,2 MPa (42 bar), from 1/2" to 3/4"  
 3,5 MPa (35 bar), from 1" a 2"  
 120 °C

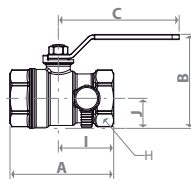

#### R911

| SIZE   | DN | A  | I  | B  | J  | C  | H  | Kv   |
|--------|----|----|----|----|----|----|----|------|
| 3/8"   | 10 | 49 | 25 | 48 | 13 | 63 | 21 | 7,0  |
| 1/2"   | 15 | 56 | 28 | 56 | 16 | 63 | 25 | 13,3 |
| 3/4"   | 20 | 62 | 31 | 64 | 21 | 73 | 32 | 25,8 |
| 1"     | 25 | 76 | 38 | 72 | 25 | 73 | 39 | 50,9 |
| 1 1/4" | 32 | 86 | 43 | 82 | 30 | 73 | 47 | 103  |

Max. working conditions with dry saturated steam:  
 Max. working pressure at 20 °C with water and safe gases:  
 Max. operating pressure (MOP) with gas:  
 Max. working pressure at 20 °C with liquid hydrocarbons:

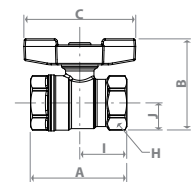

185 °C with 1,05 MPa (10,5 bar)  
 4,2 MPa (42 bar), from 3/8" to 3/4"  
 3,5 MPa (35 bar), from 1" to 1 1/4"  
 0,5 MPa (5 bar)  
 1,2 MPa (12 bar)

#### R789

| SIZE            | DN | A   | I  | B  | J  | C  | H  | H' | Kv   |
|-----------------|----|-----|----|----|----|----|----|----|------|
| 1/2" F x 1/2" M | 15 | 79  | 18 | 71 | 33 | 63 | 30 | 26 | 4,8  |
| 3/4" F x 3/4" M | 20 | 89  | 21 | 82 | 39 | 73 | 38 | 32 | 8,0  |
| 1" F x 1" M     | 25 | 100 | 25 | 94 | 46 | 73 | 46 | 41 | 21,3 |

Max. working conditions with dry saturated steam:  
 Max. working pressure at 20 °C with water:

185 °C with 1,05 MPa (10,5 bar)  
 4,2 MPa (42 bar), 1/2" and 3/4"  
 3,5 MPa (35 bar), 1"

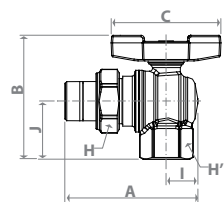

## R914

| SIZE   | DN | A   | I  | B  | J  | C  | H  | Kv   |
|--------|----|-----|----|----|----|----|----|------|
| 1/4"   | 8  | 51  | 21 | 35 | 10 | 40 | 17 | 6,9  |
| 3/8"   | 10 | 59  | 25 | 48 | 13 | 63 | 21 | 7,0  |
| 1/2"   | 15 | 68  | 28 | 55 | 16 | 63 | 25 | 13,3 |
| 3/4"   | 20 | 76  | 31 | 64 | 21 | 73 | 32 | 25,8 |
| 1"     | 25 | 87  | 38 | 72 | 25 | 73 | 39 | 50,9 |
| 1 1/4" | 32 | 102 | 43 | 82 | 30 | 73 | 47 | 103  |

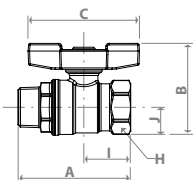

Max. working conditions with dry saturated steam:  
Max. working pressure at 20 °C with water and safe gases:

Max. operating pressure (MOP) with gas:  
Max. working pressure at 20 °C with liquid hydrocarbons:

185 °C with 1,05 MPa (10,5 bar)  
4,2 MPa (42 bar), from 1/4" to 3/4"  
3,5 MPa (35 bar), from 1" to 1 1/4"  
0,5 MPa (5bar)  
1,2 MPa (12bar)

## R914L

| SIZE   | DN | A   | I  | B   | J  | C   | H  | Kv   |
|--------|----|-----|----|-----|----|-----|----|------|
| 1/4"   | 8  | 51  | 21 | 36  | 10 | 42  | 17 | 6,9  |
| 3/8"   | 10 | 59  | 25 | 46  | 13 | 77  | 21 | 7,0  |
| 1/2"   | 15 | 68  | 28 | 52  | 16 | 77  | 25 | 13,3 |
| 3/4"   | 20 | 76  | 31 | 69  | 21 | 95  | 32 | 25,8 |
| 1"     | 25 | 88  | 39 | 77  | 25 | 95  | 39 | 50,9 |
| 1 1/4" | 32 | 102 | 43 | 87  | 30 | 95  | 47 | 103  |
| 1 1/2" | 40 | 105 | 48 | 108 | 37 | 137 | 54 | 147  |
| 2"     | 50 | 124 | 55 | 124 | 46 | 137 | 67 | 222  |

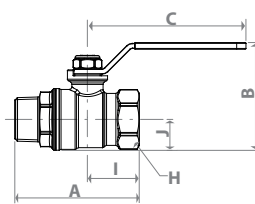

Max. working conditions with dry saturated steam:  
Max. working pressure at 20 °C with water and safe gases:

Max. operating pressure (MOP) with gas:  
Max. working pressure at 20 °C with liquid hydrocarbons:

185 °C with 1,05 MPa (10,5 bar)  
4,2 MPa (42 bar), from 1/4" to 3/4"  
3,5 MPa (35 bar), from 1" to 2"  
0,5 MPa (5 bar)  
1,2 MPa (12 bar)

## R913

| SIZE   | DN | A   | I  | B  | J  | C  | H  | Kv   |
|--------|----|-----|----|----|----|----|----|------|
| 3/8"   | 10 | 63  | 28 | 49 | 13 | 63 | 21 | 7,0  |
| 1/2"   | 15 | 74  | 34 | 55 | 17 | 63 | 25 | 13,3 |
| 3/4"   | 20 | 82  | 38 | 64 | 21 | 73 | 32 | 25,8 |
| 1"     | 25 | 93  | 44 | 73 | 25 | 73 | 39 | 50,9 |
| 1 1/4" | 32 | 108 | 50 | 82 | 30 | 73 | 47 | 103  |

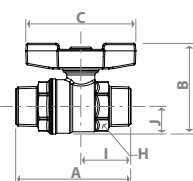

Max. working conditions with dry saturated steam:  
Max. working pressure at 20 °C with water:

185 °C with 1,05 MPa (10,5 bar)  
4,2 MPa (42 bar), from 3/8" to 3/4"  
3,5 MPa (35 bar), from 1" to 1 1/4"

## R913L

| SIZE   | DN | A   | I  | B  | J  | C  | H  | Kv   |
|--------|----|-----|----|----|----|----|----|------|
| 3/8"   | 10 | 63  | 28 | 46 | 13 | 77 | 21 | 7,0  |
| 1/2"   | 15 | 73  | 34 | 52 | 16 | 77 | 25 | 13,3 |
| 3/4"   | 20 | 82  | 38 | 69 | 21 | 95 | 32 | 25,8 |
| 1"     | 25 | 92  | 44 | 77 | 25 | 95 | 39 | 50,9 |
| 1 1/4" | 32 | 108 | 50 | 87 | 30 | 95 | 47 | 103  |

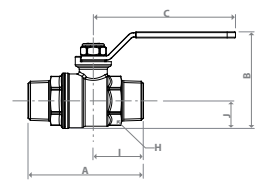

Max. working conditions with dry saturated steam:  
Max. working pressure at 20 °C:

185 °C with 1,05 MPa (10,5 bar)  
4,2 MPa (42 bar), from 3/8" to 3/4"  
3,5 MPa (35 bar), from 1" to 1 1/4"

## R919

| SIZE                | DN | A   | I  | B  | J  | C  | H  | H' | Kv   |
|---------------------|----|-----|----|----|----|----|----|----|------|
| 1/2" F x 1/2" M     | 15 | 88  | 28 | 55 | 17 | 63 | 25 | 30 | 13,3 |
| 1/2" F x 3/4" M     | 15 | 90  | 28 | 59 | 21 | 63 | 25 | 38 | 13,3 |
| 3/4" F x 3/4" M     | 20 | 97  | 32 | 65 | 22 | 73 | 32 | 38 | 25,8 |
| 3/4" F x 1" M       | 20 | 101 | 31 | 67 | 23 | 73 | 32 | 46 | 25,8 |
| 1" F x 1" M         | 25 | 109 | 38 | 72 | 25 | 73 | 39 | 46 | 50,9 |
| 1" F x 1 1/4" M     | 25 | 115 | 38 | 77 | 30 | 73 | 39 | 53 | 50,9 |
| 1 1/4" F x 1 1/4" M | 32 | 123 | 43 | 82 | 30 | 73 | 48 | 53 | 103  |

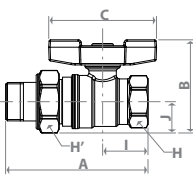

Max. working conditions with dry saturated steam:  
Max. working pressure at 20 °C with water:

185 °C with 1,05 MPa (10,5 bar)  
4,2 MPa (42 bar), from 1/2" x 1/2" to 3/4" x 1"  
3,5 MPa (35 bar), from 1" x 1" to 1 1/4" x 1 1/4"

## R919S

| SIZE                | DN | A   | I  | B  | J  | C  | H  | H' | Kv   |
|---------------------|----|-----|----|----|----|----|----|----|------|
| 1/2" F x 1/2" M     | 15 | 93  | 34 | 55 | 17 | 63 | 25 | 30 | 13,3 |
| 1/2" F x 3/4" M     | 15 | 96  | 34 | 59 | 21 | 63 | 25 | 38 | 13,3 |
| 3/4" F x 3/4" M     | 20 | 103 | 37 | 65 | 21 | 73 | 32 | 38 | 25,8 |
| 3/4" F x 1" M       | 20 | 107 | 37 | 69 | 26 | 73 | 32 | 46 | 25,8 |
| 1" F x 1" M         | 25 | 115 | 44 | 72 | 26 | 73 | 39 | 46 | 50,9 |
| 1" F x 1 1/4" M     | 25 | 121 | 44 | 77 | 30 | 73 | 39 | 53 | 50,9 |
| 1 1/4" F x 1 1/4" M | 32 | 135 | 57 | 82 | 30 | 73 | 48 | 53 | 103  |

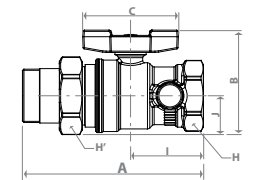

Max. working pressure at 20 °C with water:

Max. operating working temperature:

4,2 MPa (42 bar), from 1/2" x 1/2" to 3/4" x 1"  
3,5 MPa (35 bar), from 1" x 1" to 1 1/4" x 1 1/4"  
120 °C

## R919

| SIZE                | DN | A   | I  | B  | J  | C  | H  | H' | Kv   |
|---------------------|----|-----|----|----|----|----|----|----|------|
| 1/2" F x 1/2" M     | 15 | 88  | 28 | 55 | 17 | 63 | 25 | 30 | 13,3 |
| 1/2" F x 3/4" M     | 15 | 90  | 28 | 59 | 21 | 63 | 25 | 38 | 13,3 |
| 3/4" F x 3/4" M     | 20 | 97  | 32 | 65 | 22 | 73 | 32 | 38 | 25,8 |
| 3/4" F x 1" M       | 20 | 101 | 31 | 67 | 23 | 73 | 32 | 46 | 25,8 |
| 1" F x 1" M         | 25 | 109 | 38 | 72 | 25 | 73 | 39 | 46 | 50,9 |
| 1" F x 1 1/4" M     | 25 | 115 | 38 | 77 | 30 | 73 | 39 | 53 | 50,9 |
| 1 1/4" F x 1 1/4" M | 32 | 123 | 43 | 82 | 30 | 73 | 48 | 53 | 103  |

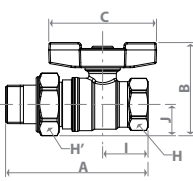

Max. working conditions with dry saturated steam:  
Max. working pressure at 20 °C with water:

185 °C with 1,05 MPa (10,5 bar)  
4,2 MPa (42 bar), from 1/2" x 1/2" to 3/4" x 1"  
3,5 MPa (35 bar), from 1" x 1" to 1 1/4" x 1 1/4"

## R919S

| SIZE                | DN | A   | I  | B  | J  | C  | H  | H' | Kv   |
|---------------------|----|-----|----|----|----|----|----|----|------|
| 1/2" F x 1/2" M     | 15 | 93  | 34 | 55 | 17 | 63 | 25 | 30 | 13,3 |
| 1/2" F x 3/4" M     | 15 | 96  | 34 | 59 | 21 | 63 | 25 | 38 | 13,3 |
| 3/4" F x 3/4" M     | 20 | 103 | 37 | 65 | 21 | 73 | 32 | 38 | 25,8 |
| 3/4" F x 1" M       | 20 | 107 | 37 | 69 | 26 | 73 | 32 | 46 | 25,8 |
| 1" F x 1" M         | 25 | 115 | 44 | 72 | 26 | 73 | 39 | 46 | 50,9 |
| 1" F x 1 1/4" M     | 25 | 121 | 44 | 77 | 30 | 73 | 39 | 53 | 50,9 |
| 1 1/4" F x 1 1/4" M | 32 | 135 | 57 | 82 | 30 | 73 | 48 | 53 | 103  |

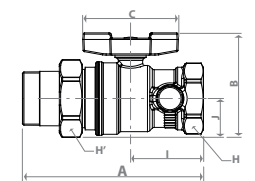

Max. working pressure at 20 °C with water:

Max. operating working temperature:

4,2 MPa (42 bar), from 1/2" x 1/2" to 3/4" x 1"  
3,5 MPa (35 bar), from 1" x 1" to 1 1/4" x 1 1/4"  
120 °C



## R850

| SIZE   | DN | A   | I  | B   | J  | C   | H  | Kv   |
|--------|----|-----|----|-----|----|-----|----|------|
| 1/4"   | 8  | 43  | 21 | 36  | 10 | 43  | 17 | 6,6  |
| 3/8"   | 10 | 46  | 23 | 45  | 13 | 77  | 20 | 6,7  |
| 1/2"   | 15 | 53  | 27 | 51  | 16 | 77  | 25 | 12,7 |
| 3/4"   | 20 | 60  | 30 | 67  | 20 | 95  | 31 | 24,6 |
| 1"     | 25 | 74  | 37 | 76  | 25 | 95  | 38 | 48,5 |
| 1 1/4" | 32 | 84  | 42 | 85  | 29 | 95  | 47 | 98,0 |
| 1 1/2" | 40 | 95  | 47 | 104 | 35 | 137 | 54 | 140  |
| 2"     | 50 | 109 | 54 | 120 | 43 | 137 | 66 | 211  |

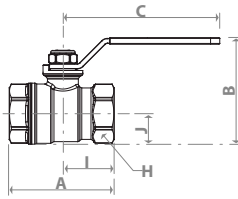

Max. working conditions with dry saturated steam:  
 Max. working pressure at 20 °C with water and safe gases:  
 Max. operating pressure (MOP) with gas:  
 Max. working pressure at 20 °C with liquid hydrocarbons:

185 °C with 1,05 MPa (10,5 bar)  
 3,5 MPa (35 bar), from 1/4" to 3/4"  
 2,8 MPa (28 bar), from 1" to 2"  
 0,5 MPa (5 bar)  
 1,2 MPa (12 bar)

## R851

| SIZE   | DN | A  | I  | B  | J  | C  | H  | Kv   |
|--------|----|----|----|----|----|----|----|------|
| 1/4"   | 8  | 43 | 21 | 35 | 10 | 40 | 17 | 6,6  |
| 3/8"   | 10 | 46 | 23 | 48 | 13 | 63 | 20 | 6,7  |
| 1/2"   | 15 | 53 | 27 | 54 | 16 | 63 | 25 | 12,7 |
| 3/4"   | 20 | 60 | 30 | 63 | 20 | 73 | 31 | 24,6 |
| 1"     | 25 | 74 | 37 | 72 | 25 | 73 | 38 | 48,5 |
| 1 1/4" | 32 | 84 | 42 | 82 | 29 | 73 | 47 | 98,0 |

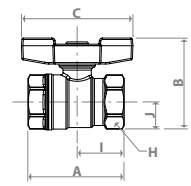

Max. working conditions with dry saturated steam:  
 Max. working pressure at 20 °C with water and safe gases:  
 Max. operating pressure (MOP) with gas:  
 Max. working pressure at 20 °C with liquid hydrocarbons:

185 °C with 1,05 MPa (10,5 bar)  
 3,5 MPa (35 bar), from 1/4" to 3/4"  
 2,8 MPa (28 bar), from 1" to 1 1/4"  
 0,5 MPa (5 bar)  
 1,2 MPa (12 bar)

## R851TH

| SIZE   | DN | A   | I  | B   | J  | C  | H  | Kv   |
|--------|----|-----|----|-----|----|----|----|------|
| 3/8"   | 10 | 46  | 23 | 73  | 13 | 78 | 20 | 6,7  |
| 1/2"   | 15 | 53  | 27 | 80  | 16 | 78 | 25 | 12,7 |
| 3/4"   | 20 | 60  | 30 | 89  | 20 | 78 | 31 | 24,6 |
| 1"     | 25 | 74  | 37 | 98  | 24 | 78 | 38 | 48,5 |
| 1 1/4" | 32 | 84  | 42 | 108 | 30 | 78 | 47 | 98,0 |
| 1 1/2" | 40 | 95  | 47 | 141 | 35 | 96 | 54 | 140  |
| 2"     | 50 | 109 | 54 | 156 | 43 | 96 | 66 | 211  |

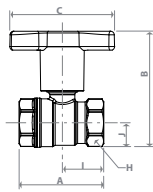

Max. working pressure at 20 °C with water and safe gases:  
 Max. operating pressure (MOP) with gas:

3,5 MPa (35 bar), from 3/8" to 3/4"  
 2,8 MPa (28 bar), from 1" to 2"  
 0,5 MPa (5 bar)

## R854

| SIZE   | DN | A  | I  | B  | J  | C  | H  | Kv   |
|--------|----|----|----|----|----|----|----|------|
| 1/2"   | 15 | 64 | 27 | 54 | 16 | 63 | 25 | 12,7 |
| 3/4"   | 20 | 72 | 30 | 64 | 20 | 73 | 31 | 24,6 |
| 1"     | 25 | 83 | 37 | 72 | 24 | 73 | 38 | 48,5 |
| 1 1/4" | 32 | 97 | 42 | 82 | 29 | 73 | 47 | 98,0 |

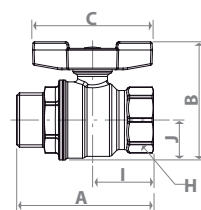

Max. working pressure at 20 °C with water and safe gases:  
 Max. operating pressure:  
 Max. working conditions with dry saturated steam:

3,5 MPa (35 bar) from 1/2" - 3/4"  
 2,8 MPa (28 bar) from 1" - 1 1/4"  
 20 °C with 50 % glycol solutions  
 185 °C with 1,05 MPa (10,5 bar)

## R851TH

| SIZE   | DN | A   | I  | B   | J  | C  | H  | Kv   |
|--------|----|-----|----|-----|----|----|----|------|
| 3/8"   | 10 | 46  | 23 | 73  | 13 | 78 | 20 | 6,7  |
| 1/2"   | 15 | 53  | 27 | 80  | 16 | 78 | 25 | 12,7 |
| 3/4"   | 20 | 60  | 30 | 89  | 20 | 78 | 31 | 24,6 |
| 1"     | 25 | 74  | 37 | 98  | 24 | 78 | 38 | 48,5 |
| 1 1/4" | 32 | 84  | 42 | 108 | 30 | 78 | 47 | 98,0 |
| 1 1/2" | 40 | 95  | 47 | 141 | 35 | 96 | 54 | 140  |
| 2"     | 50 | 109 | 54 | 156 | 43 | 96 | 66 | 211  |

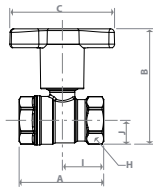

Max. working pressure at 20 °C with water and safe gases:  
 Max. operating pressure (MOP) with gas:

3,5 MPa (35 bar), from 3/8" to 3/4"  
 2,8 MPa (28 bar), from 1" to 2"  
 0,5 MPa (5 bar)

## R854

| SIZE   | DN | A  | I  | B  | J  | C  | H  | Kv   |
|--------|----|----|----|----|----|----|----|------|
| 1/2"   | 15 | 64 | 27 | 54 | 16 | 63 | 25 | 12,7 |
| 3/4"   | 20 | 72 | 30 | 64 | 20 | 73 | 31 | 24,6 |
| 1"     | 25 | 83 | 37 | 72 | 24 | 73 | 38 | 48,5 |
| 1 1/4" | 32 | 97 | 42 | 82 | 29 | 73 | 47 | 98,0 |

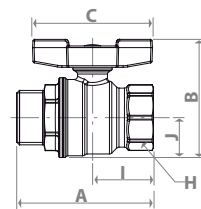

Max. working pressure at 20 °C with water and safe gases:  
 Max. operating pressure:  
 Max. working conditions with dry saturated steam:

3,5 MPa (35 bar) from 1/2" - 3/4"  
 2,8 MPa (28 bar) from 1" - 1 1/4"  
 20 °C with 50 % glycol solutions  
 185 °C with 1,05 MPa (10,5 bar)

## R859

| SIZE            | DN | A   | I  | B  | J  | C  | H  | H' | Kv   |
|-----------------|----|-----|----|----|----|----|----|----|------|
| 1/2" F x 1/2" M | 15 | 86  | 27 | 55 | 17 | 63 | 25 | 30 | 12,7 |
| 3/4" F x 3/4" M | 20 | 95  | 30 | 65 | 21 | 73 | 31 | 38 | 24,6 |
| 1" F x 1" M     | 25 | 108 | 37 | 73 | 26 | 73 | 38 | 46 | 48,5 |
| 1" F x 1 1/4" M | 32 | 122 | 42 | 82 | 30 | 73 | 47 | 53 | 98,0 |

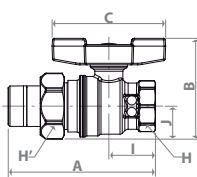

Max. working pressure at 20 °C with water and safe gases:  
 Max. operating pressure:  
 Max. working conditions with dry saturated steam:

3,5 MPa (35 bar) from 1/2" - 3/4"  
 2,8 MPa (28 bar) from 1" - 1 1/4"  
 20 °C with 50 % glycol solutions  
 185 °C con 1,05 MPa (10,5 bar)

## R250D

| SIZE   | DN | A   | I   | B   | J  | C   | H   | Kv   |
|--------|----|-----|-----|-----|----|-----|-----|------|
| 1/4"   | 8  | 43  | 21  | 36  | 10 | 43  | 17  | 6,6  |
| 3/8"   | 10 | 45  | 22  | 46  | 14 | 77  | 21  | 6,7  |
| 1/2"   | 14 | 54  | 27  | 49  | 15 | 77  | 25  | 10,2 |
| 3/4"   | 18 | 63  | 31  | 64  | 18 | 94  | 32  | 18,5 |
| 1"     | 22 | 75  | 38  | 73  | 23 | 94  | 39  | 36,3 |
| 1 1/4" | 28 | 84  | 42  | 82  | 28 | 94  | 48  | 73,5 |
| 1 1/2" | 35 | 93  | 46  | 100 | 33 | 136 | 55  | 105  |
| 2"     | 45 | 107 | 54  | 115 | 41 | 136 | 67  | 158  |
| 2 1/2" | 58 | 146 | 73  | 154 | 52 | 173 | 82  | 240  |
| 3"     | 68 | 160 | 80  | 169 | 60 | 173 | 98  | 269  |
| 4"     | 90 | 207 | 104 | 207 | 77 | 187 | 122 | 461  |

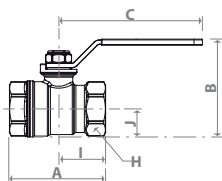

Max. working conditions with dry saturated steam:  
Max. working pressure at 20 °C with water and safe gases:

Max. operating pressure (MOP) with gas:  
Max. working pressure at 20 °C with liquid hydrocarbons:

185 °C with 1,05 MPa (10,5 bar)  
4,2 MPa (42 bar), from 1/4" to 3/4"  
3,5 MPa (35 bar), from 1" to 2"  
2,8 MPa (28 bar), from 2 1/2" to 4"  
0,5 MPa (5 bar)  
1,2 MPa (12 bar)

## R250DS

| SIZE   | DN | A   | I  | B   | J  | C   | H  | Kv   |
|--------|----|-----|----|-----|----|-----|----|------|
| 1/2"   | 14 | 59  | 32 | 49  | 15 | 77  | 25 | 10,2 |
| 3/4"   | 18 | 69  | 36 | 64  | 18 | 94  | 32 | 18,5 |
| 1"     | 22 | 81  | 43 | 73  | 23 | 94  | 39 | 36,3 |
| 1 1/4" | 28 | 98  | 56 | 82  | 28 | 94  | 48 | 73,5 |
| 1 1/2" | 35 | 107 | 60 | 100 | 33 | 136 | 55 | 105  |
| 2"     | 45 | 121 | 67 | 115 | 41 | 136 | 67 | 158  |

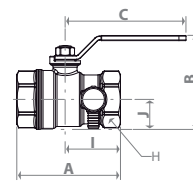

Max. working pressure at 20 °C with water: 4,2 MPa (42 bar), from 1/2" to 3/4"  
3,5 MPa (35 bar), from 1" to 2"  
Max. operating working temperature: 120 °C

## R251D

| SIZE   | DN | A  | I  | B  | J  | C  | H  | Kv   |
|--------|----|----|----|----|----|----|----|------|
| 1/4"   | 8  | 43 | 21 | 35 | 10 | 40 | 17 | 6,6  |
| 3/8"   | 10 | 45 | 22 | 46 | 14 | 63 | 21 | 6,7  |
| 1/2"   | 14 | 54 | 27 | 51 | 15 | 63 | 25 | 10,2 |
| 3/4"   | 18 | 63 | 31 | 60 | 18 | 73 | 32 | 18,5 |
| 1"     | 22 | 75 | 38 | 73 | 23 | 73 | 39 | 36,3 |
| 1 1/4" | 28 | 84 | 42 | 78 | 28 | 73 | 48 | 73,5 |

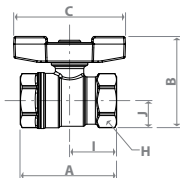

Max. working conditions with dry saturated steam:  
Max. working pressure at 20 °C with water and safe gases:

Max. operating pressure (MOP) with gas:  
Max. working pressure at 20 °C with liquid hydrocarbons:

185 °C with 1,05 MPa (10,5 bar)  
4,2 MPa (42 bar), from 1/4" to 3/4"  
3,5 MPa (35 bar), from 1" to 1 1/4"  
0,5 MPa (5 bar)  
1,2 MPa (12 bar)

## R251S

| SIZE | DN | A  | I  | B  | J  | C  | H  | Kv   |
|------|----|----|----|----|----|----|----|------|
| 1/2" | 14 | 59 | 32 | 50 | 15 | 63 | 25 | 10,2 |
| 3/4" | 18 | 69 | 36 | 60 | 18 | 73 | 32 | 18,5 |
| 1"   | 22 | 81 | 43 | 69 | 23 | 73 | 39 | 36,3 |

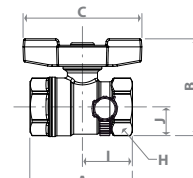

Max. working pressure at 20 °C with water and safe gases:

Temperature range:

4,2 MPa (42 bar) from 1/2" to 3/4"  
3,5 MPa (35 bar) from 1"  
-20 ÷ 120 °C  
(20 °C with 50 % glycol solutions)

## R251T

| SIZE | DN | A  | I  | B  | J  | C  | H  | Kv   |
|------|----|----|----|----|----|----|----|------|
| 3/4" | 18 | 63 | 31 | 79 | 37 | 73 | 32 | 18,5 |
| 1"   | 22 | 75 | 38 | 82 | 37 | 73 | 39 | 36,3 |

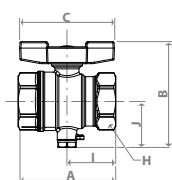

Max. working pressure at 20 °C with water and safe gases:

Temperature range:

4,2 MPa (42 bar) from 3/4"  
3,5 MPa (35 bar) from 1"  
-20 ÷ 120 °C  
(20 °C with 50 % glycol solutions)

## R251TH

| SIZE   | DN | A   | I  | B   | J  | C  | H  | Kv   |
|--------|----|-----|----|-----|----|----|----|------|
| 3/8"   | 10 | 45  | 23 | 75  | 14 | 78 | 21 | 6,7  |
| 1/2"   | 14 | 54  | 27 | 77  | 15 | 78 | 25 | 10,2 |
| 3/4"   | 18 | 63  | 31 | 86  | 18 | 78 | 32 | 18,5 |
| 1"     | 22 | 75  | 38 | 95  | 23 | 78 | 39 | 36,3 |
| 1 1/4" | 28 | 86  | 42 | 104 | 28 | 78 | 48 | 73,5 |
| 1 1/2" | 35 | 95  | 46 | 136 | 33 | 98 | 55 | 105  |
| 2"     | 45 | 107 | 54 | 152 | 41 | 98 | 67 | 158  |

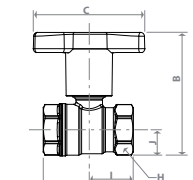

Max. working pressure at 20 °C with water and safe gases:

Max. operating working temperature:

4,2 MPa (42 bar), from 3/8" to 3/4"  
3,5 MPa (35 bar), from 1" to 2"  
110 °C

## R254D

| SIZE   | DN | A   | I  | B  | J  | C  | H  | Kv   |
|--------|----|-----|----|----|----|----|----|------|
| 1/4"   | 8  | 51  | 21 | 35 | 10 | 40 | 17 | 6,6  |
| 3/8"   | 10 | 55  | 22 | 46 | 14 | 63 | 21 | 6,7  |
| 1/2"   | 14 | 64  | 27 | 51 | 15 | 63 | 25 | 10,2 |
| 3/4"   | 18 | 76  | 31 | 60 | 18 | 73 | 32 | 18,5 |
| 1"     | 22 | 89  | 38 | 69 | 23 | 73 | 39 | 36,3 |
| 1 1/4" | 28 | 100 | 42 | 78 | 28 | 73 | 48 | 73,5 |

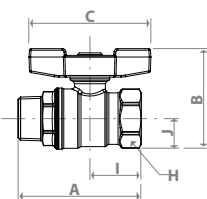

Max. working conditions with dry saturated steam:  
Max. working pressure at 20 °C with water and safe gases:

Max. operating pressure (MOP) with gas:  
Max. working pressure at 20 °C with liquid hydrocarbons:

185 °C with 1,05 MPa (10,5 bar)  
4,2 MPa (42 bar), from 1/4" to 3/4"  
3,5 MPa (35 bar), from 1" to 1 1/4"  
0,5 MPa (5 bar)  
1,2 MPa (12 bar)

## R254DL

| SIZE   | DN | A   | I  | B   | J  | C   | H  | Kv   |
|--------|----|-----|----|-----|----|-----|----|------|
| 1/4"   | 8  | 51  | 21 | 36  | 10 | 43  | 17 | 6,6  |
| 3/8"   | 10 | 55  | 22 | 46  | 14 | 77  | 21 | 6,7  |
| 1/2"   | 14 | 64  | 27 | 49  | 15 | 77  | 25 | 10,2 |
| 3/4"   | 18 | 76  | 31 | 64  | 18 | 94  | 32 | 18,5 |
| 1"     | 22 | 86  | 38 | 73  | 23 | 94  | 39 | 36,3 |
| 1 1/4" | 28 | 100 | 42 | 82  | 28 | 94  | 48 | 73,5 |
| 1 1/2" | 35 | 105 | 46 | 100 | 33 | 136 | 55 | 105  |
| 2"     | 45 | 124 | 54 | 115 | 41 | 136 | 67 | 158  |

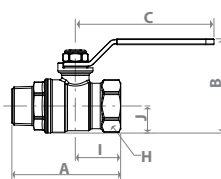

Max. working conditions with dry saturated steam:  
Max. working pressure at 20 °C with water and safe gases:

Max. operating pressure (MOP) with gas:  
Max. working pressure at 20 °C with liquid hydrocarbons:

185 °C a 1,05 MPa (10,5 bar)  
4,2 MPa (42 bar), from 1/4" to 3/4"  
3,5 MPa (35 bar), from 1" to 2"  
0,5 MPa (5 bar)  
1,2 MPa (12 bar)

**R253D**

| SIZE   | DN | A   | I  | B  | J  | C  | H  | Kv   |
|--------|----|-----|----|----|----|----|----|------|
| 3/8"   | 10 | 58  | 26 | 49 | 14 | 63 | 19 | 6,7  |
| 1/2"   | 14 | 66  | 29 | 51 | 15 | 63 | 22 | 10,2 |
| 3/4"   | 18 | 79  | 33 | 60 | 19 | 73 | 29 | 18,5 |
| 1"     | 22 | 91  | 40 | 69 | 23 | 73 | 36 | 36,3 |
| 1 1/4" | 28 | 108 | 47 | 78 | 28 | 73 | 44 | 73,5 |

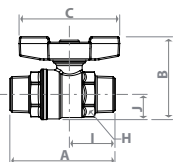

Max. working conditions with dry saturated steam:  
Max. working pressure at 20 °C with water and safe gases:

Max. operating pressure (MOP) with gas:  
Max. working pressure at 20 °C with liquid hydrocarbons:

185 °C with 1,05 MPa (10,5 bar)  
4,2 MPa (42 bar), from 3/8" to 3/4"  
3,5 MPa (35 bar), from 1" to 1 1/4"  
0,5 MPa (5 bar)  
1,2 MPa (12 bar)

**R253DL**

| SIZE   | DN | A   | I  | B  | J  | C  | H  | Kv   |
|--------|----|-----|----|----|----|----|----|------|
| 3/8"   | 10 | 58  | 26 | 49 | 14 | 77 | 19 | 6,7  |
| 1/2"   | 14 | 66  | 29 | 51 | 15 | 77 | 22 | 10,2 |
| 3/4"   | 18 | 79  | 33 | 60 | 19 | 94 | 29 | 18,5 |
| 1"     | 22 | 91  | 40 | 69 | 23 | 94 | 36 | 36,3 |
| 1 1/4" | 28 | 108 | 47 | 78 | 28 | 94 | 44 | 73,5 |

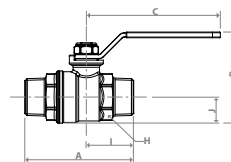

Max. working conditions with dry saturated steam:  
Max. working pressure at 20 °C with water and safe gases:

Max. operating pressure (MOP) with gas:  
Max. working pressure at 20 °C with liquid hydrocarbons:

185 °C with 1,05 MPa (10,5 bar)  
4,2 MPa (42 bar), from 3/8" to 3/4"  
3,5 MPa (35 bar), from 1" to 1 1/4"  
0,5 MPa (5 bar)  
1,2 MPa (12 bar)

**R259D**

| SIZE                | DN | A   | I  | B  | J  | C  | H  | H' | Kv   |
|---------------------|----|-----|----|----|----|----|----|----|------|
| 1/2" F x 1/2" M     | 14 | 86  | 27 | 53 | 17 | 63 | 25 | 30 | 10,2 |
| 1/2" F x 3/4" M     | 14 | 87  | 27 | 57 | 21 | 63 | 25 | 38 | 10,2 |
| 3/4" F x 3/4" M     | 18 | 96  | 31 | 63 | 21 | 73 | 32 | 38 | 18,5 |
| 3/4" F x 1" M       | 18 | 101 | 31 | 67 | 26 | 73 | 32 | 46 | 18,5 |
| 1" F x 1" M         | 22 | 110 | 38 | 72 | 26 | 73 | 39 | 46 | 36,3 |
| 1" F x 1 1/4" M     | 22 | 114 | 38 | 76 | 30 | 73 | 39 | 53 | 36,3 |
| 1 1/4" F x 1 1/4" M | 28 | 125 | 42 | 80 | 30 | 73 | 48 | 53 | 73,5 |

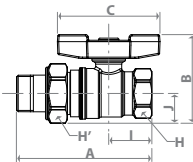

Max. working conditions with dry saturated steam: 185 °C with 1,05 MPa (10,5 bar)

Max. working pressure at 20 °C with water: 4,2 MPa (42 bar), from 1/2" to 3/4"  
3,5 MPa (35 bar), from 1" to 1 1/4"

**R259DS**

| SIZE                | DN | A   | I  | B  | J  | C  | H  | H' | Kv   |
|---------------------|----|-----|----|----|----|----|----|----|------|
| 1/2" F x 1/2" M     | 14 | 91  | 32 | 53 | 17 | 63 | 25 | 30 | 10,2 |
| 1/2" F x 3/4" M     | 14 | 93  | 32 | 57 | 21 | 63 | 25 | 38 | 10,2 |
| 3/4" F x 3/4" M     | 18 | 102 | 37 | 63 | 21 | 73 | 32 | 38 | 18,5 |
| 3/4" F x 1" M       | 18 | 107 | 37 | 67 | 26 | 73 | 32 | 46 | 18,5 |
| 1" F x 1" M         | 22 | 116 | 53 | 72 | 26 | 73 | 39 | 46 | 36,3 |
| 1" F x 1 1/4" M     | 22 | 120 | 53 | 76 | 30 | 73 | 39 | 53 | 36,3 |
| 1 1/4" F x 1 1/4" M | 28 | 138 | 56 | 80 | 30 | 73 | 48 | 53 | 73,5 |

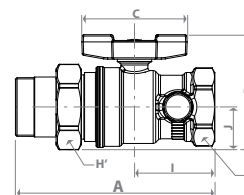

Max. working pressure at 20 °C with water: 4,2 MPa (42 bar), from 1/2" to 3/4"  
3,5 MPa (35 bar), from 1" to 1 1/4"

Max. operating working temperature: 120 °C

**R259DST**

| SIZE        | DN | A   | I  | B  | J  | C  | H  | H <sub>1</sub> | Kv   |
|-------------|----|-----|----|----|----|----|----|----------------|------|
| 1" F x 1" M | 22 | 126 | 53 | 72 | 26 | 73 | 40 | 46             | 36,3 |

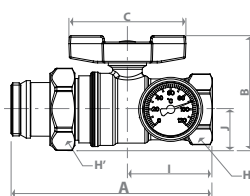

Max. working pressure at 20 °C with water: 4,2 MPa (42 bar), from 1/2" to 3/4"  
3,5 MPa (35 bar), from 1" to 1 1/4"

Max. operating working temperature: 120 °C

**R259T**

| SIZE (axb)      | DN | A   | I  | B  | J  | C  | H  | H' | Kv   |
|-----------------|----|-----|----|----|----|----|----|----|------|
| 3/4" F x 3/4" M | 18 | 97  | 31 | 79 | 37 | 73 | 32 | 38 | 18,5 |
| 3/4" F x 1" M   | 18 | 101 | 31 | 80 | 38 | 73 | 32 | 46 | 18,5 |
| 1" F x 1" M     | 22 | 110 | 38 | 82 | 36 | 73 | 39 | 46 | 36,3 |

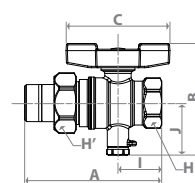

Max. working pressure at 20 °C with water: 4,2 MPa (42 bar), 3/4"  
3,5 MPa (35 bar), 1"

Max. operating working temperature: 120 °C

**R285**

| SIZE                | DN | A  | I  | B   | J  | C  | H  | Kv   |
|---------------------|----|----|----|-----|----|----|----|------|
| 1" F x 1 1/2" M     | 22 | 79 | 42 | 92  | 23 | 73 | 39 | 36,3 |
| 1 1/4" F x 1 1/2" M | 28 | 88 | 46 | 110 | 28 | 73 | 48 | 73,5 |
| 1 1/4" F x 2" M     | 28 | 88 | 46 | 110 | 28 | 73 | 48 | 73,5 |

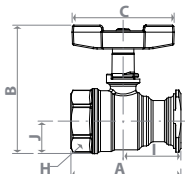

Max. working conditions with dry saturated steam: 185 °C with 1,05 MPa (10,5 bar)  
Max. working pressure at 20 °C with water: 3,5 MPa (35 bar)

**R285L**

| SIZE                | DN | A  | I  | B   | J  | C  | H  | Kv   |
|---------------------|----|----|----|-----|----|----|----|------|
| 1" F x 1 1/2" M     | 22 | 79 | 42 | 95  | 23 | 94 | 40 | 36,3 |
| 1 1/4" F x 1 1/2" M | 28 | 88 | 46 | 113 | 28 | 94 | 48 | 73,5 |
| 1 1/4" F x 2" M     | 28 | 88 | 46 | 113 | 28 | 94 | 48 | 73,5 |

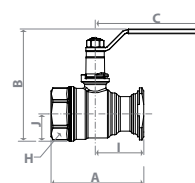

Max. working conditions with dry saturated steam: 185 °C with 1,05 MPa (10,5 bar)  
Max. working pressure at 20 °C with water: 3,5 MPa (35 bar)

## R251P

| SIZE            | DN | A  | I  | B  | J  | C  | H  | H <sub>1</sub> | Kv   |
|-----------------|----|----|----|----|----|----|----|----------------|------|
| 1/2" F x 3/4" F | 14 | 62 | 27 | 54 | 18 | 63 | 25 | 30             | 10,2 |
| 3/4" F x 3/4" F | 14 | 63 | 28 | 54 | 18 | 63 | 32 | 30             | 10,2 |
| 3/4" F x 1" F   | 18 | 85 | 31 | 63 | 21 | 73 | 32 | 37             | 18,5 |
| 1" F x 1" F     | 22 | 85 | 38 | 69 | 23 | 73 | 40 | 37             | 36,3 |

Max. working conditions with dry saturated steam:

185 °C with 1,05 MPa (10,5 bar)

Max. working pressure at 20 °C with water:

4,2 MPa (42 bar), 1/2" and 3/4"

3,5 MPa (35 bar), 1"

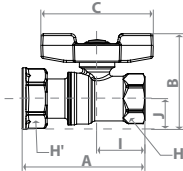

## R254P

| SIZE            | DN | A  | I  | B  | J  | C  | H  | Kv   |
|-----------------|----|----|----|----|----|----|----|------|
| 1/2" M x 3/4" F | 14 | 71 | 29 | 54 | 18 | 63 | 30 | 10,2 |
| 3/4" M x 3/4" F | 14 | 75 | 35 | 54 | 18 | 63 | 30 | 18,5 |

Max. working conditions with dry saturated steam:

185 °C with 1,05 MPa (10,5 bar)

Max. working pressure at 20 °C with water:

4,2 MPa (42 bar)

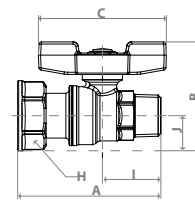

## R752

| SIZE          | DN | A  | A'  | I  | B  | J  | C  | H  | H' | Kv   |
|---------------|----|----|-----|----|----|----|----|----|----|------|
| 1/2" F x 4" F | 15 | 74 | 82  | 30 | 56 | 18 | 63 | 26 | 30 | 12,7 |
| 3/4" F x 1" F | 20 | 94 | 102 | 35 | 65 | 21 | 73 | 32 | 35 | 24,6 |

Max. working conditions with dry saturated steam:

185 °C with 1,05 MPa (10,5 bar)

Max. working pressure at 20 °C with water:

4,2 MPa (42 bar)

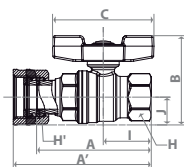

## R252

| SIZE                    | A      | B      | C    |
|-------------------------|--------|--------|------|
| 1" F x calotta 1 1/2" F | 1"     | 1 1/2" | 53   |
| 1 1/4" F x calotta 2" F | 1 1/4" | 2      | 66,5 |

Max. working temperature:

Static pressure:

Temperature range:

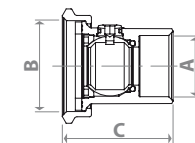

7 bar  
40 bar (with completely shut or completely open valve)  
5 ÷ 110 °C

## R790

| RP   | A  | I  | B  | J  | C  | H  | P  | Kv   | G      |
|------|----|----|----|----|----|----|----|------|--------|
| 3/4" | 78 | 44 | 64 | 21 | 73 | 32 | 73 | 24,6 | 1 1/4" |
| 1"   | 90 | 49 | 73 | 24 | 73 | 40 | 76 | 48,5 | 1 1/2" |

Gas-based systems for domestic (or similar) use,  
from main gas supply line (UNI7129-1:2008)

Max. operating pressure (MOP) with gas:

0,5 MPa (5 bar)

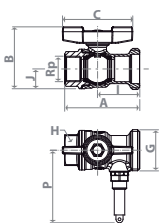

## R790B

| RP   | A  | I  | B   | J  | C  | H  | P  | Kv   | G      |
|------|----|----|-----|----|----|----|----|------|--------|
| 3/4" | 78 | 44 | 109 | 21 | 78 | 32 | 73 | 24,6 | 1 1/4" |
| 1"   | 90 | 49 | 117 | 24 | 78 | 40 | 76 | 48,5 | 1 1/2" |

Gas-based systems for domestic (or similar) use,  
from main gas supply line (UNI7129-1:2008)

Max. operating pressure (MOP) with gas:

0,5 MPa (5 bar)

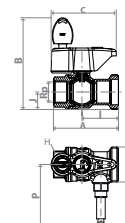

| G      | RP   | L  | H' | H" | R    | L  | H' | V  | L  | H' |
|--------|------|----|----|----|------|----|----|----|----|----|
| 1 1/4" | 3/4" | 22 | 46 | 32 | 3/4" | 33 | 46 | 22 | 44 | 46 |
| 1 1/2" | 1"   | 22 | 53 | 38 | 1"   | 36 | 53 | 28 | 44 | 53 |

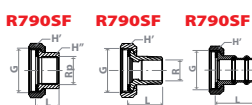

| G      | RP   | L  | H' | H" | R    | L  | H' | V  | L  | H' |
|--------|------|----|----|----|------|----|----|----|----|----|
| 1 1/4" | 3/4" | 22 | 46 | 32 | 3/4" | 33 | 46 | 22 | 44 | 46 |
| 1 1/2" | 1"   | 22 | 53 | 38 | 1"   | 36 | 53 | 28 | 44 | 53 |

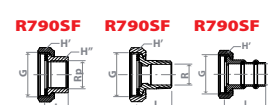

## R792

| RP   | A  | I  | B  | J  | C  | H  | P  | Kv   | G      |
|------|----|----|----|----|----|----|----|------|--------|
| 3/4" | 68 | 31 | 82 | 38 | 73 | 32 | 77 | 24,6 | 1 1/4" |
| 1"   | 79 | 35 | 90 | 42 | 73 | 40 | 81 | 48,5 | 1 1/2" |

Gas-based systems for domestic (or similar) use,  
from main gas supply line (UNI7129-1:2008)

Max. operating pressure (MOP) with gas:

0,5 MPa (5 bar)

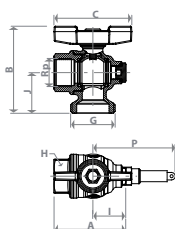

## R792B

| RP   | A  | I  | B   | J  | C  | H  | P  | Kv   | G      |
|------|----|----|-----|----|----|----|----|------|--------|
| 3/4" | 78 | 44 | 109 | 21 | 78 | 32 | 73 | 24,6 | 1 1/4" |
| 1"   | 90 | 49 | 117 | 24 | 78 | 40 | 76 | 48,5 | 1 1/2" |

Gas-based systems for domestic (or similar) use,  
from main gas supply line (UNI7129-1:2008)

Max. operating pressure (MOP) with gas:

0,5 MPa (5 bar)

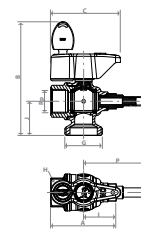

| G      | RP   | L  | H' | H" | R    | L  | H' | V  | L  | H' |
|--------|------|----|----|----|------|----|----|----|----|----|
| 1 1/4" | 3/4" | 22 | 46 | 32 | 3/4" | 33 | 46 | 22 | 44 | 46 |
| 1 1/2" | 1"   | 22 | 53 | 38 | 1"   | 36 | 53 | 28 | 44 | 53 |

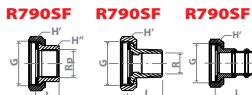

| G      | RP   | L  | H' | H" | R    | L  | H' | V  | L  | H' |
|--------|------|----|----|----|------|----|----|----|----|----|
| 1 1/4" | 3/4" | 22 | 46 | 32 | 3/4" | 33 | 46 | 22 | 44 | 46 |
| 1 1/2" | 1"   | 22 | 53 | 38 | 1"   | 36 | 53 | 28 | 44 | 53 |

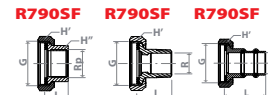



**R780**

| SIZE | DN | A  | I  | B  | J  | C  | H  | Kv   |
|------|----|----|----|----|----|----|----|------|
| 1/2" | 15 | 50 | 18 | 78 | 40 | 63 | 26 | 4,8  |
| 3/4" | 20 | 58 | 21 | 86 | 43 | 73 | 32 | 8,0  |
| 1"   | 25 | 69 | 25 | 97 | 50 | 73 | 41 | 21,3 |

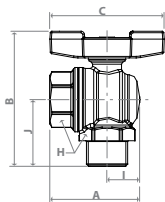

Max. working conditions with dry saturated steam:  
Max. working pressure at 20 °C with water and safe gases:

Max. operating pressure (MOP) with gas:  
Max. working pressure at 20 °C with liquid hydrocarbons:

185 °C with 1,05 MPa (10,5 bar)  
4,2 MPa (42 bar), 1/2" and 3/4"  
3,5 MPa (35 bar), 1"  
0,5 MPa (5 bar)  
1,2 MPa (12 bar)

**R780L**

| SIZE | DN | A  | I  | B   | J  | C  | H  | Kv   |
|------|----|----|----|-----|----|----|----|------|
| 1/2" | 15 | 50 | 18 | 76  | 40 | 77 | 26 | 4,8  |
| 3/4" | 20 | 58 | 21 | 90  | 43 | 94 | 32 | 8,0  |
| 1"   | 25 | 69 | 25 | 101 | 50 | 94 | 41 | 21,3 |

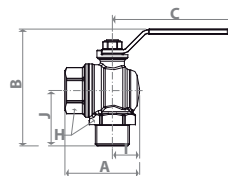

Max. working conditions with dry saturated steam:  
Max. working pressure at 20 °C with water and safe gases:

Max. operating pressure (MOP) with gas:  
Max. working pressure at 20 °C with liquid hydrocarbons:

185 °C with 1,05 MPa (10,5 bar)  
4,2 MPa (42 bar), 1/2" and 3/4"  
3,5 MPa (35 bar), 1"  
0,5 MPa (5 bar)  
1,2 MPa (12 bar)

**R781**

| SIZE | DN | A  | I  | B  | J  | C  | H  | H' | Kv   |
|------|----|----|----|----|----|----|----|----|------|
| 1/2" | 15 | 58 | 18 | 71 | 33 | 63 | 22 | 26 | 4,8  |
| 3/4" | 20 | 67 | 21 | 82 | 39 | 73 | 29 | 32 | 8,0  |
| 1"   | 25 | 79 | 25 | 94 | 46 | 73 | 36 | 41 | 21,3 |

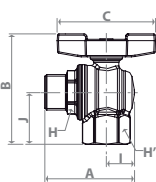

Max. working conditions with dry saturated steam:  
Max. working pressure at 20 °C with water and safe gases:

Max. operating pressure (MOP) with gas:  
Max. working pressure at 20 °C with liquid hydrocarbons:

185 °C with 1,05 MPa (10,5 bar)  
4,2 MPa (42 bar), from 1/2" to 3/4"  
3,5 MPa (35 bar), 1"  
0,5 MPa (5 bar)  
1,2 MPa (12 bar)

**R781L**

| SIZE | DN | A  | I  | B  | J  | C  | H  | H' | Kv   |
|------|----|----|----|----|----|----|----|----|------|
| 1/2" | 15 | 58 | 18 | 69 | 33 | 77 | 22 | 26 | 4,8  |
| 3/4" | 20 | 67 | 21 | 86 | 39 | 94 | 29 | 32 | 8,0  |
| 1"   | 25 | 79 | 25 | 98 | 46 | 94 | 36 | 41 | 21,3 |

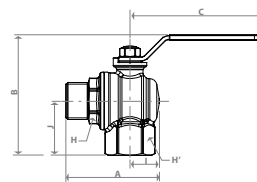

Max. working conditions with dry saturated steam:  
Max. working pressure at 20 °C with water and safe gases:

Max. operating pressure (MOP) with gas:  
Max. working pressure at 20 °C with liquid hydrocarbons:

185 °C with 1,05 MPa (10,5 bar)  
4,2 MPa (42 bar), 1/2" and 3/4"  
3,5 MPa (35 bar), 1"  
0,5 MPa (5 bar)  
1,2 MPa (12 bar)

**R782**

| SIZE | DN | A  | I  | B  | J  | C  | H  | H' | Kv   |
|------|----|----|----|----|----|----|----|----|------|
| 1/2" | 15 | 58 | 18 | 78 | 40 | 63 | 22 | 26 | 4,8  |
| 3/4" | 20 | 67 | 21 | 86 | 43 | 73 | 29 | 32 | 8,0  |
| 1"   | 25 | 79 | 25 | 97 | 50 | 73 | 36 | 41 | 21,3 |

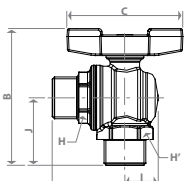

Max. working conditions with dry saturated steam:  
Max. working pressure at 20 °C with water and safe gases:

Max. operating pressure (MOP) with gas:  
Max. working pressure at 20 °C with liquid hydrocarbons:

185 °C with 1,05 MPa (10,5 bar)  
4,2 MPa (42 bar), from 1/2" to 3/4"  
3,5 MPa (35 bar), 1"  
0,5 MPa (5 bar)  
1,2 MPa (12 bar)

**R782L**

| SIZE | DN | A  | I  | B   | J  | C  | H  | H' | Kv   |
|------|----|----|----|-----|----|----|----|----|------|
| 1/2" | 15 | 58 | 18 | 76  | 40 | 77 | 22 | 26 | 4,8  |
| 3/4" | 20 | 67 | 21 | 90  | 43 | 94 | 29 | 32 | 8,0  |
| 1"   | 25 | 79 | 25 | 101 | 50 | 94 | 36 | 41 | 21,3 |

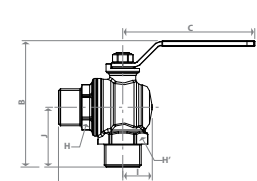

Max. working conditions with dry saturated steam:  
Max. working pressure at 20 °C with water and safe gases:

Max. operating pressure (MOP) with gas:  
Max. working pressure at 20 °C with liquid hydrocarbons:

185 °C with 1,05 MPa (10,5 bar)  
4,2 MPa (42 bar), from 1/2" to 3/4"  
3,5 MPa (35 bar), 1"  
0,5 MPa (5 bar)  
1,2 MPa (12 bar)

**R783**

| SIZE | DN | A  | I  | B  | J  | C  | H  | Kv   |
|------|----|----|----|----|----|----|----|------|
| 1/2" | 15 | 50 | 18 | 71 | 33 | 63 | 22 | 4,8  |
| 3/4" | 20 | 58 | 21 | 82 | 39 | 73 | 29 | 8,0  |
| 1"   | 25 | 69 | 25 | 94 | 46 | 73 | 36 | 21,3 |

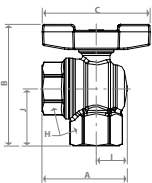

Max. working conditions with dry saturated steam:  
Max. working pressure at 20 °C with water and safe gases:

Max. operating pressure (MOP) with gas:  
Max. working pressure at 20 °C with liquid hydrocarbons:

185 °C with 1,05 MPa (10,5 bar)  
4,2 MPa (42 bar), from 1/2" to 3/4"  
3,5 MPa (35 bar), 1"  
0,5 MPa (5 bar)  
1,2 MPa (12 bar)

**R783L**

| SIZE | DN | A  | I  | B  | J  | C  | H  | Kv   |
|------|----|----|----|----|----|----|----|------|
| 1/2" | 15 | 50 | 18 | 69 | 33 | 77 | 22 | 4,8  |
| 3/4" | 20 | 58 | 21 | 86 | 39 | 94 | 29 | 8,0  |
| 1"   | 25 | 69 | 25 | 98 | 46 | 94 | 36 | 21,3 |

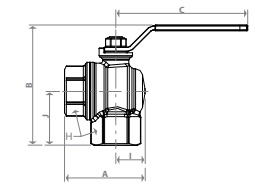

Max. working conditions with dry saturated steam:  
Max. working pressure at 20 °C with water and safe gases:

Max. operating pressure (MOP) with gas:  
Max. working pressure at 20 °C with liquid hydrocarbons:

185 °C with 1,05 MPa (10,5 bar)  
4,2 MPa (42 bar), from 1/2" to 3/4"  
3,5 MPa (35 bar), 1"  
0,5 MPa (5 bar)  
1,2 MPa (12 bar)

## Ball valves with press connections

NB: check the operating conditions by referring to the specific Technical Datasheet

### R850VW

| MISURA | DN | A   | I  | B   | J  | C   | Kv  |
|--------|----|-----|----|-----|----|-----|-----|
| ø42    | 40 | 158 | 79 | 106 | 36 | 136 | 140 |
| ø54    | 50 | 186 | 91 | 122 | 44 | 136 | 211 |

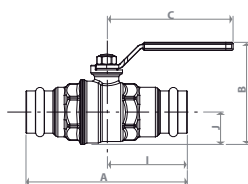

Max. working pressure at 20 °C with water: **2,8 MPa (28 bar)**  
 Max. operating working temperature: **110 °C**

### R850VWS

| MISURA         | DN | A   | I  | B   | J  | C   | H  | Kv  |
|----------------|----|-----|----|-----|----|-----|----|-----|
| 1 1/2" F x ø42 | 40 | 141 | 62 | 106 | 36 | 136 | 54 | 140 |
| 2" F x ø54     | 50 | 165 | 69 | 122 | 44 | 136 | 67 | 211 |

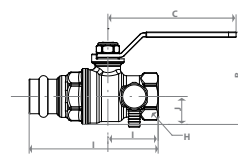

Massima pressione di esercizio a 20 °C con acqua: **3,5 MPa (35 bar), da 15 a 22**  
**2,8 MPa (28 bar), da 28 a 54**  
 Max. operating working temperature: **110 °C**

### R851VT

| MISURA | DN | A   | I  | B   | J  | C  | Kv   |
|--------|----|-----|----|-----|----|----|------|
| ø18    | 15 | 100 | 50 | 80  | 16 | 78 | 12,7 |
| ø15    | 15 | 100 | 50 | 81  | 17 | 78 | 12,7 |
| ø22    | 20 | 116 | 58 | 90  | 20 | 78 | 24,6 |
| ø28    | 25 | 122 | 61 | 98  | 25 | 78 | 48,5 |
| ø35    | 32 | 130 | 65 | 108 | 30 | 78 | 98,0 |

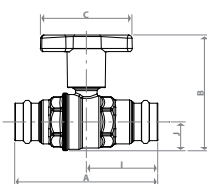

Max. working pressure at 20 °C with water: **3,5 MPa (35 bar), from 15 to 22**  
**2,8 MPa (28 bar), from 28 to 35**  
 Max. operating working temperature: **110 °C**

### R851VTS

| MISURA         | DN | A   | I  | B   | J  | C  | H  | Kv   |
|----------------|----|-----|----|-----|----|----|----|------|
| 1/2" F x ø18   | 15 | 84  | 34 | 81  | 17 | 78 | 25 | 12,7 |
| 1/2" F x ø15   | 15 | 84  | 34 | 81  | 17 | 78 | 25 | 12,7 |
| 3/4" F x ø22   | 20 | 95  | 37 | 91  | 21 | 78 | 31 | 24,6 |
| 1" F x ø28     | 25 | 105 | 44 | 98  | 25 | 78 | 39 | 48,5 |
| 1 1/4" F x ø35 | 32 | 122 | 57 | 108 | 30 | 78 | 48 | 98,0 |

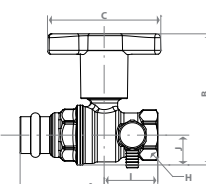

Max. working pressure at 20 °C with water: **3,5 MPa (35 bar), from 15 to 22**  
**2,8 MPa (28 bar), from 28 to 35**  
 Max. operating working temperature: **110 °C**

### R853VT

| MISURA         | DN | A   | I  | B   | J  | C  | H  | Kv   |
|----------------|----|-----|----|-----|----|----|----|------|
| 1/2" M x ø18   | 15 | 86  | 50 | 81  | 17 | 78 | 22 | 12,7 |
| 1/2" M x ø15   | 15 | 86  | 50 | 81  | 17 | 78 | 22 | 12,7 |
| 3/4" M x ø22   | 20 | 99  | 58 | 90  | 21 | 78 | 29 | 24,6 |
| 1" M x ø28     | 25 | 107 | 61 | 99  | 25 | 78 | 36 | 48,5 |
| 1 1/4" M x ø35 | 32 | 120 | 65 | 109 | 30 | 78 | 44 | 98,0 |

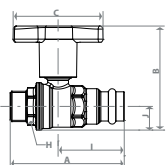

Max. working pressure at 20 °C with water: **3,5 MPa (35 bar), from 15 to 22**  
**2,8 MPa (28 bar), from 28 to 35**  
 Max. operating working temperature: **110 °C**

### R853VWL

| MISURA         | DN | A   | I  | B   | J  | C   | H  | Kv  |
|----------------|----|-----|----|-----|----|-----|----|-----|
| 1 1/2" M x ø42 | 40 | 136 | 76 | 107 | 37 | 137 | 54 | 140 |
| 2" M x ø54     | 50 | 159 | 91 | 122 | 44 | 137 | 67 | 211 |

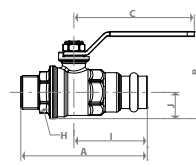

Max. working pressure at 20 °C with water: **2,8 MPa (28 bar)**  
 Temperature range: **5÷110 °C**

### R854VT

| MISURA         | DN | A   | I  | B   | J  | C  | H  | Kv   |
|----------------|----|-----|----|-----|----|----|----|------|
| 1/2" F x ø18   | 15 | 80  | 50 | 81  | 17 | 78 | 26 | 12,7 |
| 1/2" F x ø15   | 15 | 80  | 50 | 81  | 17 | 78 | 26 | 12,7 |
| 3/4" F x ø22   | 20 | 92  | 58 | 90  | 21 | 78 | 32 | 24,6 |
| 1" F x ø28     | 25 | 102 | 61 | 99  | 25 | 78 | 41 | 48,5 |
| 1 1/4" F x ø35 | 32 | 112 | 65 | 108 | 30 | 78 | 50 | 98,0 |

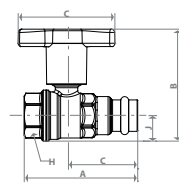

Max. working pressure at 20 °C with water: **3,5 MPa (35 bar), from 15 to 22**  
**2,8 MPa (28 bar), from 28 to 54**  
 Max. operating working temperature: **110 °C**

### R854VWL

| MISURA         | DN | A   | I  | B   | J  | C   | H  | Kv  |
|----------------|----|-----|----|-----|----|-----|----|-----|
| 1 1/2" F x ø42 | 40 | 131 | 79 | 107 | 37 | 137 | 55 | 140 |
| 2" F x ø54     | 50 | 154 | 91 | 122 | 44 | 137 | 69 | 211 |

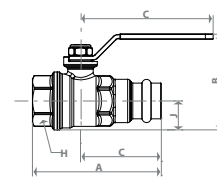

Max. working pressure at 20 °C with water: **2,8 MPa (28 bar), from 28 to 54**  
 Temperature range: **5÷110 °C**

### R859VT

| MISURA         | DN | A   | I  | B   | J  | C  | H  | Kv   |
|----------------|----|-----|----|-----|----|----|----|------|
| 1/2" M x ø18   | 15 | 112 | 50 | 81  | 17 | 78 | 30 | 12,7 |
| 1/2" M x ø15   | 15 | 112 | 50 | 81  | 17 | 78 | 30 | 12,7 |
| 3/4" M x ø22   | 20 | 127 | 57 | 91  | 21 | 78 | 38 | 24,6 |
| 1" M x ø28     | 25 | 135 | 61 | 100 | 26 | 78 | 46 | 48,5 |
| 1 1/4" M x ø35 | 32 | 150 | 65 | 108 | 30 | 78 | 53 | 98,0 |

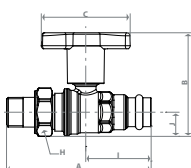

Max. working pressure at 20 °C with water: **3,5 MPa (35 bar), from 15 to 22**  
**2,8 MPa (28 bar), from 28 to 35**  
 Max. operating working temperature: **110 °C**

### R850V

| MISURA | DN | A   | I  | B   | J  | C   | Kv   |
|--------|----|-----|----|-----|----|-----|------|
| ø15    | 15 | 100 | 50 | 53  | 17 | 77  | 12,7 |
| ø22    | 20 | 16  | 58 | 69  | 20 | 95  | 24,6 |
| ø28    | 25 | 122 | 61 | 77  | 25 | 95  | 48,5 |
| ø35    | 32 | 130 | 65 | 87  | 30 | 95  | 98,0 |
| ø42    | 40 | 158 | 79 | 106 | 36 | 136 | 140  |
| ø54    | 50 | 186 | 91 | 122 | 44 | 136 | 211  |

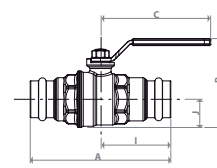

Max. working pressure at 20 °C with liquid hydrocarbons: **1,2 MPa (12 bar)**  
 Max. operating pressure (MOP) with gas: **0,5 MPa (5 bar)**  
 Temperature range: **-20÷60 °C**